

Please do not destroy or throw away this publication. If you have no further use for it, write to the State Board of Water Engineers at Austin and ask for postage to return it.

\* \* \*

TEXAS

\* \* \*

STATE BOARD OF WATER ENGINEERS

C. S. Clark, Chairman

A. H. Dunlap, Member

J. W. Pritchett, Member

\* \* \* \*

FORT BEND COUNTY, TEXAS  
(West of the Brazos River)

Records of wells, drillers' logs,  
and water analyses, and maps  
showing location of wells.

\* \* \* \* \*

WORKS PROGRESS ADMINISTRATION

GROUND WATER SURVEY

PROJECT 2080

G. A. Elledge  
Project Superintendent

\* \* \* \* \*

Analyses made, maps prepared, data  
assembled, and report mimeographed by  
WORKS PROGRESS ADMINISTRATION  
PROJECT 6507-5112

\* \* \* \* \*

Sponsored by the State Board of Water Engineers with  
the Bureau of Industrial Chemistry of the University  
of Texas and the U. S. Geological Survey cooperating.

\* \* \* \* \*

Austin, Texas  
Mar. 1, 1937

FORT BEND COUNTY, TEXAS  
(West of the Brazos River)

\* \* \*

Introduction  
by  
Samuel F. Turner  
Associate Hydraulic Engineer  
U. S. Geological Survey

The purpose of this survey was to obtain information concerning existing wells and springs and the quantity and quality of water they yield, and to put down test holes where additional information is needed.

This project was part of a statewide Works Progress Administration project known as a "Statewide Inventory of Water Wells," sponsored by the State Board of Water Engineers. The Division of Ground Water of the U. S. Geological Survey cooperated in the technical direction of the project and the Bureau of Industrial Chemistry of The University of Texas furnished laboratory space and equipment and supervised the chemical analyses.

The analyses were made by chemists employed on Works Progress Administration Project 6507-5112 at Austin, Texas, sponsored by the State Board of Water Engineers. This release was typed and assembled by typists and draftsmen employed on this project.

The northeastern part of Fort Bend County, north and east of the Brazos River, was covered in 1931 and 1932 by the U. S. Geological Survey and the Texas Board of Water Engineers in connection with an investigation of the ground-water supply of the Houston-Galveston area. Therefore, the field work on the present project was limited to the western part of Fort Bend County, west and south of the Brazos River.

The field work was started on December 12, 1935, and completed on May 30, 1936. This project was Project 2080 of District 6 of the Works Progress Administration, Houston, Texas. G. A. Elledge, a geologist, was project superintendent. Mr. Elledge deserves credit for his work and for the many extra hours he spent on the project. The Houston office of the Works Progress Administration made this work possible by their constant help and cooperation.

This release contains the well and spring records and well logs obtained by the project superintendent, logs of the test holes drilled by the W. P. A. labor, and the chemical analyses of water from privately owned wells and springs. Locations of all wells and springs listed are shown on plates 1 to 5 inclusive in the back of the release.

The test wells were drilled by W. P. A. labor using a soil auger, drop auger, churn drill and a sand bucket. Samples were collected at one foot intervals by the well driller in charge of the party. The project superintendent studied these samples and compiled the logs.

Records of wells west of the Brazos River in Fort Bend County, Texas.  
(See "Logs of W. P. A. Test Wells" for all records of test wells.)

No.	Distance from Orchard	Survey	Owner	Driller	Date completed	Depth of well (ft.) a/	Diameter of well (in.)
e/ 1	3 $\frac{1}{4}$ miles northwest	Shelby-Frazier & McCormick	F. Bland	-- Gahler	1930	60	10
5	2 $\frac{3}{4}$ mile west	Gail Borden Jr.	H. H. Aylor Est.	--	--	85	--
e/ 6	In Orchard	do.	A. F. Sager	Layne-Texas Co.	1909	361	9-5/8
11	1 $\frac{1}{4}$ miles north	do.	-- Zamowitz	--	--	139	--
13	2 miles north	do.	Joe Hede	--	--	76	2
15	2 miles northeast	Sarah Kennedy	W. A. Hinsch	--	--	375	--
e/ 16	3 miles northeast	do.	Mrs. Lottie D. Moore	P. S. Griffith et al.	1921	4,208	--
25	5 miles southeast	Yandell Ferris	Leo Turk	Wence Gerle	1929	92	--

No.	Distance from Beasley	Survey	Owner	Driller	Date completed	Depth of well (ft.) a/	Diameter of well (in.)
106	5 $\frac{1}{2}$ miles northwest	Andrew Northington	C. N. Williamson	--	1909	95	2
110	4 $\frac{3}{4}$ miles northwest	do.	Farmers Gin Co.	G. Mahler	1930	105	4
111	do.	M. Perry	B. E. Tavner	Jno. Shruban	1907	90	2
113	4 miles west	Samuel N. Cross	Ed. Behrens	-- Sharp	1901	32	2
114	3 $\frac{1}{2}$ miles northwest	B. B. B. & C. R. Co.	Willie Sbrush	Fred Gruenwald	1926	82	2
119	do.	do.	A. E. Quinn	C. Mahler	1923	85	2
122	3 $\frac{1}{2}$ miles north	S. A. & M. G. R. Co.	Lydia Wenzel	do.	1929	100	2
124	3 $\frac{1}{4}$ miles north	Sec. No. 24, L. E. Cross	Willie Mae Wenzel	H. Ellerson	1929	64	--
126	3 $\frac{1}{2}$ miles north	Sec. No. 23, B. B. & C. R. R. Co.	S. P. R. R. Co.	--	--	42-d	30
127	do.	Sec. No. 24, L. E. Cross	H. F. Miller	H. Ellerson	1928	112	2
129	do.	Sec. No. 25, B. B. & C. R. R. Co.	Dr. E. R. Knolle	G. Mahler	1932	90	--
130	3 $\frac{3}{4}$ miles northeast	do.	F. J. Mikulancak	Jap. Saunders	--	110	--
132	2 $\frac{1}{4}$ miles northeast	Sec. No. 17, S. A. & M. G. R. Co.	Henry Kumaga	--	1920	70	2

a/ All wells are bored or driven unless dug well is indicated by "d" under "Depth."  
 b/ Measuring point was at ground level unless otherwise noted under "Remarks."  
 c/ T, turbine; A, air-lift; C, cylinder; B, bucket; E, electric; G, gasoline engine; W, windmill; H, hand; number indicates horsepower.

Records obtained by G. A. Elledge, Project Superintendent  
(Chemical analyses of water from these wells are in the table of analyses.)

No.	Water Level		Pump and power c/ d/	Use of water d/	Remarks
	Depth below ground (ft.) <u>b/</u>	Date of measure- ment			
1	48	Apr. 13, 1936	C,H	D,S	Concrete curb. Concrete casing. Measuring point was 10 inches above ground.
5	--	--	--	--	See log.
6	56	July 31, 1936 <u>f/</u>	T,E,-	--	Do.
11	32	Mar. 18, 1936 <u>f/</u>	--	--	Elevation: 108 feet above sea level.
13	36	do.	--	--	2 inch casing set in gravel.
15	52	Mar. 19, 1936 <u>f/</u>	--	--	Formerly pumped 800 gallons a minute. Shut down since 1916.
16	--	--	None	N	Oil test. See log.
25	30	Apr. 7, 1936	C,W	--	No casing.

No.	Water Level		Pump and power c/ d/	Use of water d/	Remarks
	Depth below ground (ft.) <u>b/</u>	Date of measure- ment			
106	--	--	C,W	D,S	1½ inch screen on bottom of casing.
110	25	Apr. 25, 1936 <u>f/</u>	C,-,-	Ind	Reported working barrel set at 35 feet. Used to cool engines.
111	30	Apr. 21, 1936 <u>f/</u>	C,W	D	Water reported in sand and gravel.
113	18	May 4, 1936 <u>f/</u>	C,W	D,S	Reported casing driven 4 feet in gravel.
114	35	Apr. 21, 1936 <u>f/</u>	C,H	D,S	
119	22	do.	C,W	D,S	
122	35	Apr. 7, 1936 <u>f/</u>	C,W	D,S	
124	34	do.	C,H	D,S	No casing.
126	39	Apr. 7, 1936	B,H	S	Tile casing. Measuring point was inner rim of tile casing, ½ foot above ground. Fails in summer.
127	38	Apr. 7, 1936 <u>f/</u>	C,W	D,S	
129	30	do.	C,G,-	D,S	No casing. Powered by Ford motor.
130	--	--	C,W	D,S	No casing.
132	24	May 11, 1936	C,W	D,S	Pump set at 40 feet. Reported water in sand and gravel.

d/ I, irrigation; Ind, industrial; P, public; D, domestic; S, stock; Of, oil field; N, not used.

e/ No water sample collected for analysis.

f/ Water level reported.



## Records of wells west of the Brazos River in Fort Bend County--Continued.

No.	Distance from Beasley	Survey	Owner	Driller	Date completed	Depth of well (ft.)	Diameter of well (in.)
133	2 miles northeast	Sec. No. 17, S. A. & M. G. R. R. Co.	F. X. Joerger	Joe Bohachek	1928	90	2
134	1 $\frac{3}{4}$ miles northeast	do.	W. M. Bolton	Gates Jenkins	1935	110	2
136	1 $\frac{1}{4}$ miles northeast	do.	F. X. Joerger	H. Ellerson	1934	96	--
138	$\frac{3}{4}$ mile northeast	I. & G. N. R. R. Co.	Hodde & Glissman	do.	1931	22	--
140	$\frac{1}{4}$ mile southwest	Sec. No. 15, S. A. & M. G. R. R. Co.	Farmers Gin Co.	Fred Gruenwald	1934	96	4
142	$\frac{1}{2}$ mile southwest	Sec. No. 3, S. A. & M. G. R. R. Co.	H. A. Krause	--	--	50	--
143	$\frac{3}{4}$ mile southwest	do.	Vencil Bros.	H. Goshack	1931	90	2
144	1 mile southwest	do.	K. Resicke	--	1921	68	2
145	1 $\frac{1}{2}$ miles southwest	Sec. No. 4, S. N. Cross	John Holub	--	1926	86	2
147	2 miles southwest	do.	Dennis Spencer	Joe Bohachek	1920	90	2
149	2 miles west	do.	Fred Gruenwald	Fred Gruenwald	1930	100	2
150	2 $\frac{1}{4}$ miles west	B. B. B. & C. R. R. Co.	Louis Hickman	H. Ellerson	1913	98	2
152	3 miles southwest	Sec. No. 5, Gabriel Cole	M. Andrus Estate	Joe Bohachek	1925	90	2
154	3 $\frac{3}{4}$ miles west	do.	Joe Bohachek	do.	1922	20	12
155	4 $\frac{1}{2}$ miles west	do.	Kendleton School	do.	1903	85	--
156	6 miles west	Joseph Powell	Mary Jones	Jno. Shruban	1933	110	--
157	5 $\frac{1}{4}$ miles west	Joseph M. McCormick	Joe Leonard	Joe Bohachek	--	115	2
158	5 miles west	do.	A. Toliver	--	1910	33-d	--
160	5 $\frac{1}{2}$ miles southwest	Isaac McGary	Chas. King Estate	--	1923	60	2
161	6 $\frac{3}{4}$ miles southwest	do.	V. L. King	Joe Bohachek	1916	100	2
163	5 $\frac{3}{4}$ miles southwest	do.	Kate Neal	do.	1916	90	--
165	5 $\frac{1}{2}$ miles southwest	do.	H. M. Moore	H. Ellerson	--	90	2
166	4 $\frac{3}{4}$ miles southwest	do.	A. T. Taylor	--	--	60	--
168	6 miles southwest	Elizabeth Powell	R. H. Darst	--	--	19-d	--
169	6 $\frac{1}{2}$ miles southwest	do.	Mrs. L. G. Lum	W. H. Ellison	1930	60	2
171	3 $\frac{3}{4}$ miles southwest	do.	R. H. Darst	W. H. Roper	1935	105	6
172	3 $\frac{1}{4}$ miles southwest	do.	do.	Howard Pillard	1926	90	2

## G. A. Elledge, Project Superintendent

No.	Water Level		Pump and power c/ d/	Use of water d/	Remarks
	Depth below ground (ft.)h/	Date of measure- ment			
133	--	--	C,W	--	
134	30	Apr. 8, 1936 f/	C,H	D,S	
136	35	do.	C,H	D,S	
138	20	do.	C,W	--	Cased with 1 joint of pipe. Sand point on bottom.
140	35	Apr. 27, 1936 f/	C,-,-	Ind	Used to cool Diesel engines.
142	20	Apr. 8, 1936 f/	C,H	D,S	No casing.
143	--	--	C,H	D,S	
144	--	--	C,W	--	
145	40	Apr. 8, 1936 f/	C,-,-	D	Water reported in gravel. 6 feet of screen on bottom of casing.
147	--	--	C,W	D,S	Water reported in gravel. 4 feet of screen on bottom of casing.
149	40	May 22, 1936 f/	C,W	D,S	Water reported in gravel.
150	40	do.	C,W	D,S	Do.
152	--	--	C,-	D	4 feet of screen on bottom of casing.
154	13	May 5, 1936 f/	C,W	D,S	Concrete casing. Water reported in clay. Never fails.
155	27	May 4, 1936 f/	C,W	D,P	Water reported in gravel. Quicksand reported at 34 feet.
156	50	do.	C,W	D,S	Water reported in gravel.
157	--	--	C,W	D,S	
158	28	May 4, 1936	--	--	12 inch concrete casing. Measuring point was top of casing, 1.8 feet above ground.
160	--	--	C,H	D,S	Water reported in coarse sand.
161	--	--	C,W	D,S	Water reported in gravel.
163	30	May 22, 1936 f/	C,W	D,S	Water reported hard.
165	30	Apr. 8, 1936 f/	C,H	--	
166	20	do.	C,H	--	
168	14	May 22, 1936	B,H	D,S	
169	--	--	C,H	D,S	Water reported in sand.
171	21	Apr. 27, 1936	A,-,-	--	W. I. casing. Measuring point was top of casing, 1 foot above ground. Reported yield, 200 gallons a
172	20	do.	-,H	D,S	minute.

Records of wells west of the Brazos River in Fort Bend County--Continued.

No.	Distance from Beasley	Survey	Owner	Driller	Date completed	Depth of well (ft.) a/	Diameter of well (in.)
173	2 miles south	Sec. No. 90, H. & T. C. R. R. Co.	Hy. Fuchs Estate	--	1920	100	2
174	3 $\frac{1}{2}$ miles south	Sec. No. 78, H. & T. C. R. R. Co.	Wm. Fuchs Estate	--	1923	160	2
175	7 miles south	Sec. No. 2, Wm. Garnett	K. Guttenberger	Joe Myrek	1925	100	2
176	8 miles south	do.	Joseph Teykl	-- Jaggisak	1927	80	2
177	8 $\frac{1}{2}$ miles south	Sec. No. 1, Heirs of Wm. Garnett	C. H. Stegemiller	--	1918	48	--
178	10 miles south	Robert Hodges	Peter Harleca	--	1906	48	2

No.	Distance from Richmond	Survey	Owner	Driller	Date completed	Depth of well (ft.) a/	Diameter of well (in.)
e/205	3 $\frac{1}{2}$ miles southwest	Henry Scott	-- Cluks	C. Mahler	--	95	2
e/207	3 $\frac{3}{4}$ miles southwest	do.	J. M. Moore	--	1916	80	2
e/209	4 miles west	do.	W. Thielman	C. Mahler	1931	85	2
e/210	4 $\frac{1}{2}$ miles west	do.	-- Jabusch	do.	1922	80	2
e/211	do.	do.	H. F. Moers	--	--	85	2
e/213	5 miles west	Sec. No. 1, S. P. R. R. Co.	C. H. Chemosky	C. Mahler	--	80	2
e/215	5 $\frac{1}{2}$ miles west	do.	G. Gunter	do.	1929	85	2
e/216	6 miles west	do.	J. Arnie	--	--	80	2
e/217	do.	do.	Fred Kluge	H. Ellerson	1927	85	2
e/218	6 $\frac{1}{2}$ miles west	do.	Ike Walzer	C. Mahler	1924	90	2
e/220	7 miles west	Sec. No. 4, Fred G. Schmidt	August Dreibrodt	do.	--	90	2
221	8 miles west	Sec. No. 25, S.A. & M. G. R. R. Co.	Mary Pleak	H. Ellerson	1935	85	--
223	8 miles southwest	Sec. No. 19, S.A. & M. G. R. R. Co.	F. Duebbe	Theodore Rose	1914	40	2
224	7 $\frac{1}{2}$ miles southwest	Sec. No. 7, H. & T. C. R. R. Co.	Mary Pleak	--	1927	60	2
225	do.	Sec. No. 19, S.A. & M. G. R. R. Co.	F. E. Albright	H. Ellerson	--	84	--
226	do.	Sec. No. 8, Emma Meyer	-- Schulock	--	--	63	2
228	7 miles southwest	do.	Mrs. Ben Meyer	Joe Bohachek	1929	50	--

a/ All wells are bored or driven unless dug well is indicated by "d" under "Depth."

b/ Measuring point was at ground level unless otherwise noted under "Remarks."

c/ T, turbine; A, air-lift; C, cylinder; B, bucket; E, electric; G, gasoline engine; W, windmill; H, hand; number indicates horsepower.

G. A. Elledge, Project Superintendent

No.	Water Level		Pump and power <u>c/</u>	Use of water <u>d/</u>	Remarks
	Depth below ground (ft.) <u>b/</u>	Date of measurement			
173	40	May 4, 1936 <u>f/</u>	C,W	D,S	
174	40	do.	C,W	D,S	Reported pumps 50 barrels in 6 hours. Reported 6 feet of screen on bottom of casing.
175	15	May 5, 1936 <u>f/</u>	C,W	D,S	Water reported in gravel.
176	30	May 18, 1936 <u>f/</u>	C,H	D,S	
177	30	May 5, 1936 <u>f/</u>	C,W	D,S	Water reported in coarse sand.
178	22	do.	C,H	D,S	Water reported in fine sand. Sulphur odor reported.

No.	Water Level		Pump and power <u>c/</u>	Use of water <u>d/</u>	Remarks
	Depth below ground (ft.) <u>b/</u>	Date of measurement			
205	30	Dec. 13, 1935 <u>f/</u>	C,W	D,S	
207	30	Dec. 14, 1935 <u>f/</u>	C,H	D,S	
209	35	do.	C,W	D,S	
210	30	do.	C,W	D,S	
211	30	do.	C,H	D,S	
213	30	do.	C,H	D,S	
215	30	do.	C,W	D,S	
216	30	do.	C,H	D,S	
217	30	do.	C,W	D,S	
218	--	--	C,H	D,S	
220	30	Dec. 14, 1935 <u>f/</u>	C,-	--	
221	30	Apr. 8, 1936 <u>f/</u>	C,H	D,S	
223	14	do.	C,W	--	
224	20	do.	C,W	--	
225	--	--	C,W	--	
226	25	Apr. 8, 1936 <u>f/</u>	C,W	--	
228	20	do.	C,H	D,S	Water reported turbid.

l/ I, irrigation; Ind, industrial; P, public; D, domestic; S, stock; Of, oil field; N, not used.

e/ No water sample collected for analysis.

f/ Water level reported.

## Records of wells west of the Brazos River in Fort Bend County--Continued.

No.	Distance from Richmond	Survey	Owner	Driller	Date completed	Depth of well (ft.) a/	Diameter of well (in.)
229	6 $\frac{1}{2}$ miles southwest	Sec. No. 8, Emma Meyer	K. I. Dzerzanowski	C. Mahler	1931	76	--
231	6 miles southwest	Sec. No. 12, Chas. N. Simpson	F. M. Stripka	Joe Bohachek	1920	86	--
233	5 miles southwest	Henry Scott	W. F. Kelm	W. H. Roper	1931	82	2
234	4 $\frac{1}{2}$ miles southwest	do.	Ida S. Schramme	C. Mahler	1928	85	--
236	4 $\frac{1}{4}$ miles southwest	do.	Annie Reve	Fred Gruenwald	--	82	2
237	4 miles southwest	do.	Loney Reve	do.	1935	76	2
239	3 $\frac{1}{2}$ miles southwest	do.	T. A. Moore	C. Mahler	--	90	2
240	do.	do.	G. C. Baker	Gene Davis	1931	97	2
e/242	3 $\frac{1}{4}$ miles southwest	do.	Lawson & Wood	Layne-Texas Co.	1905	298	9-5/8
243	3 miles southwest	In Rosenberg	City of Rosenberg Well No. 1	do.	1931	390	12 $\frac{1}{2}$
e/244	do.	do.	City of Rosenberg Well No. 2	do.	1934	515	10
245	2 $\frac{1}{4}$ miles southwest	James Lowery	Adolph Patillo	C. Mahler	1936	82	2
246	2 miles southwest	J. W. Moore	H. P. Ross	do.	1936	80	2
247	do.	do.	County Road	--	--	483	--
249	do.	do.	County Fair Association	C. Mahler	1932	82	2
251	1 $\frac{1}{2}$ miles southwest	do.	S. W. Davis	do.	1926	92	2
252	1 $\frac{1}{4}$ miles southwest	J. T. Edwards	Joe Vasek	--	--	50	18
253	do.	do.	G. A. Reading	-- Weinbrenner	--	80	2
255	$\frac{1}{2}$ mile southwest	do.	Mrs. -- Bruner	Gene Davis	1902	82	2
256	$\frac{1}{2}$ mile west	do.	Mrs. S. L. Ferris	--	1920	86	2
257	1 $\frac{1}{4}$ miles northwest	Wm. Andrus	Vaclav Pultar	Gene Davis	1915	90	--
258	1 $\frac{1}{4}$ miles north	Jno. Little	H. W. Collins	do.	1920	95	2
259	$\frac{1}{2}$ mile north	J. T. Edwards	J. J. Adams	do.	1916	170	2
260	In Richmond	Jay Bird Park	City of Richmond	--	1934	398	10 $\frac{3}{4}$
266	3 miles southeast	Jane H. Long	A. Hagan	--	--	100	--
269	5 miles southeast	Wiley Martin	August Meyers	Gene Davis	--	79	2
270	4 $\frac{1}{2}$ miles south	Sec. No. 5, B. B. B. & C. R. R. Co.	Fi. Cobb	do.	1935	140	2

## G. A. Elledge, Project Superintendent.

No.	Water Level		Pump and power e/ d/	Use of water d/	Remarks
	Depth below ground (ft.) h/	Date of measure- ment f/			
229	26	Apr. 8, 1936 f/	C,W	D,S	
231	30	do.	C,W	D,S	
233	30	do.	C,G,-	D,S	
234	25	do.	C,W	D,S	
236	22	do.	C,H	D,S	
237	26	Apr. 5, 1936 f/	C,G,1	D,S	
239	20	do.	C,H	--	
240	23	do.	C,H	D,S	
242	28	July 15, 1905	T,E,-	--	Reported pumps 1,200 gallons a minute. See log.
243	--	--	T,E,-	P	Altitude: 103 feet. Reported pumps 840 gallons a minute. See log.
244	41	Nov. 28, 1934	T,E, 40	F	Reported pumps 570 gallons a minute. Pumping level was 75 feet. Pump set at 99 feet. See log.
245	45	Apr. 27, 1936 f/	--	--	Installation of pumping equipment not completed. Water turbid. Water in fine yellow sand.
246	40	May 5, 1936 f/	C,W	D,I	Water in coarse sand. 5 feet of screen on bottom of casing.
247	--	--	--	--	
249	40	May 27, 1936 f/	Cf,E, -	S	Cf, centrifugal pump. Water in sand.
251	40	Apr. 13, 1936 f/	C,W	D,S	Supplies dairy.
252	49	Apr. 13, 1936	B,H	D	Wood casing. Reported unfit for drinking.
253	40	Apr. 10, 1936 f/	-,H	D,S	Altitude: 90 feet.
255	40	Apr. 23, 1936 f/	C,W	D	6 feet of screen on bottom of casing.
256	30	Apr. 11, 1936 f/	C,W & E, $\frac{1}{2}$	D,S	Water reported in sand and gravel.
257	40	May 19, 1936 f/	C,W & G, $\frac{1}{2}$	D,S	Water reported in coarse sand. Necessary to replace screen in bottom, every 5 years.
258	30	do.	C,W	D,S	Water reported in coarse sand.
259	40	May 29, 1936 f/	C,W	D,S	Supplies dairy.
260	30	May --, 1934 f/	Cf,E, -	P	Cf, centrifugal pump. Pumps 239 gallons a minute. Supplies city. See log.
266	--	--	C,G,-	--	
269	40	Apr. 1, 1936 f/	C,W	--	Water reported in coarse sand.
270 TxU	25	May 7, 1936 f/	C,W	D,S	Formerly 65 feet deep but failed in 1935. Deepened to 140 feet.

## Records of wells west of the Brazos River in Fort Bend County--Continued.

No.	Distance from Richmond	Survey	Owner	Driller	Date completed	Depth of well (ft.) a/	Diameter of well (in.)
e/274	1 $\frac{1}{2}$ miles south	Jane H. Long	Mrs. Kate B. Winston	Paul Schultze	1925	4,510	--
276	3 $\frac{1}{2}$ miles south	A. P. De May	Anton Barcak	Joe Myrek	1925	82	2
277	3 $\frac{1}{2}$ miles south	Robt. E. Handy	Aug. Dolezal	Joe Gaydosik	1928	106	2
278	4 $\frac{1}{2}$ miles south	Sec. No. 11, B. B. B. & C. R. R. Co.	F. K. Joerger	--	1920	80	2
279	do.	do.	Elo Ondrej	-- Pimpler	1921	85	2
281	5 miles south	G. M. Stone	H. A. Hartlage	--	1910	80	3
283	5 $\frac{1}{2}$ miles southwest	Sec. No. 9, B. B. B. & C. R. R. Co.	Max Band	C. Mahler	1927	85	2
287	4 $\frac{1}{2}$ miles southwest	J. D. Vermillion	Emil Frank	--	1916	132	--
289	3 $\frac{1}{2}$ miles southwest	Henry Scott	Austin Young	C. Mahler	1936	92	--
291	6 miles southwest	Sec. No. 11, H. & T. C. R. R. Co.	F. Rosenbaum	do.	1900	90	2
293	do.	Hugh Rogers	H. A. Moyer	do.	--	70	--
294	7 miles southwest	I. V. Haney	K. Hillyer	do.	1924	82	2
295	8 miles southwest	Sec. No. 2, H. & T. C. R. R. Co.	Albert Cominsky	do.	1927	--	2

No.	Distance from Needville	Survey	Owner	Driller	Date completed	Depth of well (ft.) a/	Diameter of well (in.)
301	4 $\frac{1}{2}$ miles north	Sec. No. 74, H. & T. C. R. R. Co.	W. M. Lampe	C. Mahler	1923	80	2
302	4 $\frac{1}{2}$ miles north	Sec. No. 15, H. & T. C. R. R. Co.	A. Reehs	W. H. Roper	1906	108	4
303	5 $\frac{1}{2}$ miles north	Sec. No. 4, H. & T. C. R. R. Co.	Frank Broecke	Frank Broecke	1925	84	2
305	6 miles north	Heirs of Wm. Leech	A. W. Steglich	--	1926	125	--
307	6 $\frac{1}{2}$ miles north	A. J. James	Joe Sitta	Joe Sitta	1934	50	2
310	6 miles northeast	C. B. Stewart	Joe Poncik	C. Mahler	--	110	2
311	5 miles north	F. Goth	R. J. Foss	R. J. Foss	1924	192	2
e/319	6 $\frac{1}{2}$ miles northeast	Barnabas Wickson	Hubert Hausler	Navarro Oil Co.	1928	3,250	6-5/8
320	5 $\frac{1}{2}$ miles northeast	do.	Francis Psencik	--	--	27	8
321	do.	do.	do.	Will Psencik	1936	30	--

a/ All wells are bored or driven unless dug well is indicated by "d" under "Depth."

b/ Measuring point was at ground level unless otherwise noted under "Remarks."

c/ T, turbine; A, air-lift; C, cylinder; B, bucket; E, electric; G, gasoline engine; W, windmill; H, hand; number indicates horsepower.

## G. A. Elledge, Project Superintendent.

No.	Water Level		Pump and power c/ d/	Use of water d/	Remarks
	Depth below ground (ft.) <u>b/</u>	Date of measurement			
274	--	--	None	N	Oil test. See log.
276	21	Apr. 23, 1936 <u>f/</u>	C,W	D,S	6 feet of screen on bottom of casing.
277	20	do.	C,W	--	Water turbid.
278	35	do.	C,W	--	Do.
279	--	--	C,W	D,S	
281	20	Apr. 23, 1936 <u>f/</u>	C,W	D,S	Water reported in gravel. 8 feet of screen on bottom of casing.
283	30	do.	C,W	D,S	Reported working barrel sands up easily.
287	35	Apr. 27, 1936 <u>f/</u>	C,W	D,S	
289	30	do.	C,W	D,S	
291	40	May 11, 1936 <u>f/</u>	C,W	--	Water reported hard.
293	27	Apr. 27, 1936 <u>f/</u>	C,H	--	
294	35	do.	C,W	D,S	
295	--	--	C,W	D,S	

No.	Water Level		Pump and power c/ d/	Use of water d/	Remarks
	Depth below ground (ft.) <u>b/</u>	Date of measurement			
301	--	--	C,W	D,S	
302	16	Apr. 27, 1936 <u>f/</u>	C,W	D,S	Bottom 10 feet of 4-inch casing perforated, with 2-inch working barrel and 6 feet of 2-inch screen.
303	30	May 21, 1936 <u>f/</u>	C,W	D,S	Water reported in gravel.
305	30	Apr. 27, 1936 <u>f/</u>	C,W	D,S	Water reported turbid.
307	--	--	C,W	D	Water reported in sand.
310	40	Apr. 24, 1936 <u>f/</u>	C,W	D,S	
311	22	do.	C,W	D,S	
319	--	--	None	N	Oil test. See log.
320	9	May 7, 1936	None	N	Measuring point was top of tile casing, 1 foot above ground.
321	11	May 7, 1936 <u>f/</u>	C,W	D,S	

d/ I, irrigation; Ind, industrial; P, public; D, domestic; S, stock; Of, oil field; N, not used.

e/ No water sample collected for analysis.

f/ Water level reported.



## Records of wells west of the Brazos River in Fort Bend County--Continued.

No.	Distance from Needville	Survey	Owner	Driller	Date completed	Depth of well (ft.) a/	Diameter of well (in.)
322	4 $\frac{1}{2}$ miles northeast	Barnabas Wickson	Farmers Gin Co.	C. Mahler	1936	100	2
323	4 $\frac{1}{4}$ miles northeast	do.	do.	--	1916	67	1 $\frac{1}{2}$
324	4 miles northeast	Sec. No. 43, H. & T. C. R. R. Co.	Jno. Dudek	Jno. Dudek	1929	26	2
326	2 $\frac{3}{4}$ miles north	Sec. No. 70, H. & T. C. R. R. Co.	Rudolph Sitta	Joe Myrek	1926	90	2
327	do.	Sec. No. 73, H. & T. C. R. R. Co.	John Kubena	John Kubena	1919	52	--
e/329	2 $\frac{1}{4}$ miles northeast	Sec. No. 28, H. & T. C. R. R. Co.	E. O. Bartel	G. M. Goldsmith, Trustee	1928	1,152	--
330	1 $\frac{1}{2}$ miles north	do.	M. Schroder	--	--	116	2
331	2 miles northeast	Sec. No. 34, H. & T. C. R. R. Co.	Chas. Staffin	--	1926	38	2
334	$\frac{1}{4}$ mile southeast	Sec. No. 35, H. & T. C. R. R. Co.	G. M. Goldsmith	-- Boyee	1934	103	2
335	1 mile northwest	Sec. No. 24, H. & T. C. R. R. Co.	H. A. Leisner	-- Weinbrenner	1919	110	2
338	3 $\frac{1}{4}$ miles northwest	Sec. No. 76, H. & T. C. R. R. Co.	W. C. Otto	-- Pimpler	1915	108	2
340	3 $\frac{1}{2}$ miles southwest	Robert Hodges	H. A. Bushnell	Joe Myrek	--	90	1 $\frac{1}{2}$
e/341	2 miles southwest	do.	Ed. Hanzik	do.	--	135	4
e/343	2 $\frac{1}{2}$ miles east	Sec. No. 41, H. & T. C. R. R. Co.	Theo. Rose	G. M. Goldsmith	1928	1,145	6
345	2 $\frac{1}{4}$ miles southeast	Sec. No. 48, H. & T. C. R. R. Co.	August Leus	August Leus	1934	24	1 $\frac{1}{2}$
348	5 miles southeast	Sec. No. 58, H. & T. C. R. R. Co.	L. F. Goth	L. F. Goth	1930	28	1 $\frac{1}{2}$
349	5 $\frac{1}{2}$ miles east	Sec. No. 55, H. & T. C. R. R. Co.	F. Dedek	F. Dedek	1935	40	--
351	7 miles east	Geo. Waters	Texas Gulf Sulphur Co.	--	1929	556	12 $\frac{1}{2}$
353	6 $\frac{1}{2}$ miles southeast	Sec. No. 105, H. & T. C. R. R. Co.	Aug. Bosak	Aug. Bosak	1926	110	2
355	5 $\frac{1}{2}$ miles southeast	Sec. No. 63, H. & T. C. R. R. Co.	Barbara Kolar	Joe Gueidershek	1916	95	2
356	do.	do.	John Strecik	--	1913	100	2
e/357	5 $\frac{1}{2}$ miles south	George Dedrich	J. M. Moore	Rycade Oil Corp.	1925	2,003	--
358	3 $\frac{3}{4}$ miles south	Robert Hodges	J. R. Farmer	--	--	23-d	30
359	3 $\frac{1}{4}$ miles south	do.	John Petrusek	--	1914	58	2
361	4 $\frac{1}{4}$ miles south	Simon Miller	Wm. C. Banker	-- Gajdosik	1932	108	2

a/ All wells are bored or driven unless dug well is indicated by "d" under "Depth."

b/ Measuring point was at ground level unless otherwise noted under "Remarks."

c/ T, turbine; A, air-lift; C, cylinder; B, bucket; E, electric; G, gasoline engine; W, windmill; H, hand; number indicates horsepower.

G. A. Elledge, Project Superintendent.

No.	Water Level		Pump and power c/ d/	Use of water d/	Remarks
	Depth below ground (ft.) <sup>b/</sup>	Date of measure- ment f/			
322	14	May 7, 1936 f/	C,H	Ind	Water reported in gravel.
323	14	do.	--	Ind	
324	14	do.	C,W	D,S	
326	24	Apr. 24, 1936 f/	C,W	D,S	Water reported in gravel.
327	18	May 6, 1936 f/	C,W	D,S	
329	--	--	None	N	Oil test. See log.
330	20	Apr. 24, 1936 f/	C,W	D,S	
331	26	Apr. 22, 1936 f/	C,H	D,S	Water reported in 6 feet of sand at bottom under red clay.
334	20	do.	C,W	D	Supplies filling station.
335	40	May 5, 1936 f/	C,W	D,S	Water reported in sand. 7 feet of screen on bottom of casing.
338	40	do.	C,W	--	Water reported in gravel. 6 feet of screen on bottom of casing.
340	20	Apr. 30, 1936 f/	C,-	--	
341	20	do.	C,W	D,S	
343	--	--	None	N	Oil test. See log.
345	20	Apr. 22, 1936 f/	C,H	D	Water reported in fine quicksand under red clay. 6 feet of screen on bottom of casing.
348	20	May 6, 1936 f/	C,W	D,S	
349	18	May 7, 1936 f/	C,W	D,S	Water sand reported at 18 feet, but weak supply.
351	--	--	--	--	J. H. P. Davis lease. Altitude: 66.9 feet. See log.
353	25	May 5, 1936 f/	C,G,l	D,S	
355	35	do.	C,W & H	D,S	
356	20	Apr. 22, 1936	C,E,-	Ind	Supplies gin.
357	--	--	None	N	Oil test. See log.
358	20	May 18, 1936	-,H	D,S	Measuring point was top of galvanized iron casing, 1.4 feet above ground.
359	30	May 5, 1936 f/	C,W	D,S	4 feet of screen on bottom of casing.
361	30	May 18, 1936 f/	C,W	--	

d/ I, irrigation; Ind, industrial; P, public; D, domestic; S, stock; Of, oil field; N, not used.

e/ No water sample collected for analysis.

f/ Water level reported.

Records of wells west of the Brazos River in Fort Bend County--Continued.

No.	Distance from Booth	Survey	Owner	Driller	Date completed	Depth of well (ft.) a/	Diameter of well (in.)
405	$\frac{1}{4}$ mile southwest	Abner Kuykendall	Booth Estate	--	1936	421	--
406	In Booth	do.	F. R. Booth	Gene Davis	1935	179	4
407	do.	do.	Booth Estate	--	--	300	--
e/412	4 miles southeast	Horatio Chrisman	Humble Oil & Refining Co.	Humble Oil & Refining Co.	--	534	--
414	$4\frac{1}{4}$ miles southeast	do.	County School	C. Mahler	1933	420	2
e/415	$4\frac{1}{2}$ miles east	Thomas Barnett	Mrs. Emile Levy	Vacuum Oil Co.	1928	2,512	--
416	5 miles east	Horatio Chrisman	-- Scott	--	--	90	2
417	$5\frac{1}{2}$ miles east	do.	J. W. Hampil	--	--	60	--
420	$4\frac{3}{4}$ miles southeast	Samuel Kennedy	Rudolph Gubbels	--	1919	185	2
422	$3\frac{3}{4}$ miles southeast	Horatio Chrisman	Y. U. Jones Estate	Gene Davis	--	209	2
429	5 miles southwest	W. T. Austin	Percy Gonyo	do.	1925	85	2
430	$5\frac{1}{2}$ miles south	G. S. & F. R. R. Co.	Slavik Estate	do.	1910	85	--
432	$6\frac{1}{2}$ miles southeast	John Rabb	H. O. & R. Co.	H. O. & R. Co.	1932	590	$10\frac{3}{4}$
433	8 miles south	Samuel Pharr	Ralph Rawlings	Joe Gueidershek	1926	105	2
434	$9\frac{1}{2}$ miles south	Geo. Menefee	T. A. Brown	Gene Davis	1924	130	2
435	$10\frac{1}{2}$ miles south	Sec. No. 112, H. & T. C. R. R. Co.	J. H. P. Davis	Mine Brenner	1930	80	2
436	12 miles south	Kinchen W. Davis	J. M. Mitchen	do.	1929	86	2
e/437	15 miles south	Thomas Alsberry	W. R. Nash	Rycade Oil Corp.	1928	4,900	--
e/438	do.	H. N. Cleveland	Fritz Meir	do.	1925	1,712	--

a/ All wells are bored or driven unless dug well is indicated by "d" under "Depth."

b/ Measuring point was at ground level unless otherwise noted under "Remarks."

c/ T, turbine; A, air-lift; C, cylinder; B, bucket; E, electric; G, gasoline engine; W, windmill; H, hand; number indicates horsepower.

G. A. Elledge, Project Superintendent

No.	Water Level		Pump and power <u>c/</u>	Use of water <u>d/</u>	Remarks
	Depth below ground (ft.) <u>b/</u>	Date of measurement			
405	--	--	--	--	
406	17	Apr. 2, 1936 <u>f/</u>	C,W & E,-	D,S	42 feet of galvanized pipe casing. 8 feet of screen on bottom of casing.
407	--	--	--	--	Estimated production: 70 gallons a minute.
412	--	--	--	--	Supplies camp. See log.
414	20	May 28, 1936 <u>f/</u>	C,H	D,P	Supplies school.
415	--	--	None	N	Oil test. See log.
416	--	--	C,W	--	
417	--	--	--	--	
420	20	May 12, 1936 <u>f/</u>	C,W	D,S	Water reported in gravel.
422	49	Apr. 4, 1936 <u>f/</u>	C,W	--	Water reported in sand.
429	15	May 1, 1936 <u>f/</u>	C,H	D,S	
430	35	do.	C,H	D,S	
432	--	--	T,E, 60	Of	Estimated production: 300 gallons a minute.
433	40	May 6, 1936 <u>f/</u>	C,W	D,S	
434	20	do.	C,W	P	Supplies school.
435	30	do.	C,W	D,S	
436	25	May 13, 1936 <u>f/</u>	C,W	D,S	
437	--	--	None	N	Oil test. See log.
438	--	--	None	N	Do.

d/ I, irrigation; Ind, industrial; P, public; D, domestic; S, stock; Of, oil field; N, not used.

e/ No water sample collected for analysis.

f/ Water level reported.

Table of Drillers' Logs of wells west of  
the Brazos River, Fort Bend County, Texas

Driller's log of well 5  
H. H. Aylor Estate.  $\frac{3}{4}$  mile west of  
Orchard.

	Thickness (feet)	Depth (feet)
Surface soil- - - - -	5	5
Red clay- - - - -	25	30
Fine sand- - - - -	47	77
Red sandy clay - - - -	8	85

Driller's log of well 6  
A. F. Sager, Owner. Orchard, Texas

	Thickness (feet)	Depth (feet)
Loam- - - - -	6	6
Clay- - - - -	19	25
Sand- - - - -	6	31
Clay- - - - -	14	45
Sand- - - - -	19	64
Gravel and clay- - - -	2	66
Clay- - - - -	44	110
Sand- - - - -	139	249
Gravel- - - - -	6	255
Sand- - - - -	16	271
Clay- - - - -	11	282
Sand and gravel - - - -	15	297
Gravel- - - - -	4	301
Sand- - - - -	6	307
Lime rock - - - - -	1	308
Sand rock- - - - -	11	319
Rock- - - - -	1	320
Sand and rock- - - - -	5	325
Rock- - - - -	1	326
Sand- - - - -	3	329
Gravel- - - - -	6	335
Rock- - - - -	1	336

MATERIAL SETTINGS: 77 feet of 24 inch  
pit casing, swaged to 283 feet of 9-5/8  
inch casing. Screens set; 175-251 feet,  
270-290 feet and 310-348 feet.

Driller's log of well 16  
P. S. Griffith et al., Mrs. Lottie D.  
Moore Estate lease. 3 miles northeast  
of Orchard.

Jonglomerate of sand, clay  
and boulders- - - - -

	Thickness (feet)	Depth (feet)
and boulders- - - - -	40	40
Sand rock- - - - -	1	41
Layers of sand and clay- - -	8	49
Hard rock and pyrites- - - -	2	51
Sand and gravel- - - - -	45	96
Sand with streaks of clay- -	61	157
Gravel- - - - -	11	168
Gray gumbo- - - - -	12	180
Fine gravel- - - - -	10	190
Sand and gravel- - - - -	60	250
Sandstone- - - - -	2	252
Blue gumbo- - - - -	17	269
Sand- - - - -	39	308

Driller's log of well 16--Continued

	Thickness (feet)	Depth (feet)
Gravel- - - - -	4	312
Gumbo- - - - -	10	322
Sand and gravel- - - - -	17	339
Sand with lime streaks- - -	29	368
Sandstone- - - - -	16	384
Gumbo- - - - -	7	391
Hard sand with lime streaks	39	430
Gumbo with streaks of lime-	41	471
Lime rock- - - - -	19	490
Gumbo- - - - -	40	530
Sandstone- - - - -	8	538
Gumbo- - - - -	12	550
Lime rock with soft streaks	26	576
Gumbo- - - - -	10	586
Sandy lime- - - - -	32	618
Blue gumbo- - - - -	88	706
Sandy shale and lime streaks, gas show- - - - -	45	751
Hard lime rock- - - - -	1	752
Blue gumbo- - - - -	97	849
Shale- - - - -	6	855
Alternate streaks of sand and lime- - - - -	10	865
Gumbo- - - - -	120	985
Alternate streaks of shale, lime, and sand- - - - -	12	997
Sandstone- - - - -	5	1002
Gumbo- - - - -	16	1018
Sticky shale- - - - -	20	1038
Blue sand with lime- - - -	26	1064
Gumbo- - - - -	52	1116
Shale with streaks of lime	3	1119
Alternate streaks of hard sand and lime- - - - -	107	1226
Gumbo- - - - -	40	1266
Alternate streaks of lime, sand, and shale - - - - -	14	1280
Hard, blue limestone- - - -	5	1285
Hard, sandy limestone - - -	22	1307
Hard sand and lime- - - -	8	1315
Water sand, shale, and lime- - - - -	12	1327
Gumbo- - - - -	11	1338
Lime cover and sand with show of oil- - - - -	4	1342
Shale streaked with lime -	5	1347
Sandy limestone- - - - -	13	1360
Sandy limestone- - - - -	40	1400
Hard shale- - - - -	9	1409
Gumbo- - - - -	20	1429
Lime rock- - - - -	4	1433
Sandy lime rock- - - - -	13	1446
Gumbo- - - - -	10	1456
Lime rock- - - - -	1	1457
TOTAL DEPTH- - - - -		4208

Table of Drillers' Logs of wells west of  
the Brazos River, Fort Bend County, Texas

Driller's log of well 242  
Lawson and Wood, Owner. Rosenberg, Texas.  
3 3/4 miles southwest of Richmond.

	Thickness (feet)	Depth (feet)
Soil and clay- - - - -	28	28
Sand- - - - -	40	68
Shale- - - - -	174	242
Sand- - - - -	56	298
MATERIAL SETTINGS: 298 feet of 9-5/8 inch casing. Screens set; 48-68 feet, and 258-298 feet.		

Driller's log of well 243  
City of Rosenberg, Municipal well no.1.  
3 miles south west of Richmond.

	Thickness (feet)	Depth (feet)
Soil- - - - -	4	4
Clay- - - - -	21	25
Sand- - - - -	16	41
Clay- - - - -	31	72
Sand- - - - -	18	90
Clay- - - - -	41	131
Sand- - - - -	68	199
Clay- - - - -	53	252
Sand (good) - - - - -	33	285
Clay- - - - -	18	303
Gumbo - - - - -	28	331
Sand and gravel- - - - -	48	379
Gumbo- - - - -	5	384
Sand- - - - -	6	390
CASING RECORD: 254 feet of 12 1/2 inch casing swaged to 126 feet of 10 inch casing. Screens set; 254-275 feet, and 335-377 feet. 3 foot nipple and valve on bottom.		

Driller's log of well 244  
City of Rosenberg, Municipal well no.2.  
3 miles southwest of Richmond.

	Thickness (feet)	Depth (feet)
Soil- - - - -	2	2
Clay- - - - -	33	35
Fine sand- - - - -	20	55
Water sand- - - - -	70	125
Sticky clay- - - - -	47	172
Water sand- - - - -	18	190
Joint clay- - - - -	57	247
Good water sand- - - - -	43	290
Clay- - - - -	14	304
Sand- - - - -	152	456
Clay- - - - -	6	462
Sand- - - - -	20	482
Clay- - - - -	8	490
Sand- - - - -	25	515

Driller's log of well 260  
City of Richmond, Jay Bird Park  
Richmond, Texas

	Thickness (feet)	Depth (feet)
Surface sandy loam- - - - -	10	10
Red sandy clay- - - - -	20	30
Red clay- - - - -	31	61
Red sand and joint clay - -	39	100
Fine gray water sand- - - -	42	142
Joint clay and sand - - - -	5	147
Medium coarse, gray water sand- - - - -	27	174
Yellow joint clay- - - - -	3	177
Medium coarse, gray water sand- - - - -	46	223
Yellow, red, joint clay- - -	22	245
Medium coarse, gray water sand- - - - -	19	264
Yellow and red joint clay- -	24	288
Coarse, gray water sand- - -	37	325
Red joint clay- - - - -	6	331
Coarse, red water sand - - -	64	395
Red joint clay- - - - -	3	398

Driller's log of well 274  
Paul Schultze, Mrs. Kate B. Winston  
lease. 1 1/2 miles south of Richmond.

	Thickness (feet)	Depth (feet)
Black surface clay- - - - -	5	5
Yellow clay- - - - -	20	25
Red sand- - - - -	20	45
Gravel- - - - -	15	60
Yellow clay- - - - -	8	68
Gravel and sand- - - - -	10	78
White coarse sand- - - - -	15	93
Clay and red gravel- - - - -	14	107
Coarse gravel- - - - -	15	122
Red and blue clay- - - - -	6	128
Fine gravel- - - - -	20	148
Red clay- - - - -	20	168
White sand- - - - -	15	183
Sand and boulders- - - - -	65	248
Gravel and water- - - - -	20	268
Red clay- - - - -	7	275
Sand and boulders - - - - -	83	358
Gravel and water sand- - - -	20	378
Brown sand- - - - -	25	403
Sand and boulders- - - - -	14	417
Red and blue clay- - - - -	24	441
White and yellow sand - - - -	6	447
White sand- - - - -	7	454
Red clay- - - - -	7	461
Sand and boulders - - - - -	70	531
Red clay and gravel - - - - -	13	544
Coarse sand- - - - -	37	581
Clay and boulders- - - - -	20	601

Table of Drillers' Logs of wells west of  
the Brazos River, Fort Bend County, Texas

Driller's log of well 274--Continued

	Thickness (feet)	Depth (feet)
Coarse gravel and clay-	-20	621
Red clay and streaks of lime-	16	637
Sandy lime-	9	646
Sandy blue gumbo-	-14	660
Red waxy clay-	-25	685
Packed sandy lime-	-10	695
Sandy lime-	9	704
Hard white sand-	5	709
Red clay and streaks of lime-	3	712
Sandy lime and boulders-	7	719
Hard water sand-	-21	740
Red clay and streaks of lime-	18	758
Sticky blue sand-	-12	770
Red clay-	2	772
Water sand-	-12	784
Packed sand and streaks of blue shale-	-16	800
Loose water sand-	-40	840
Red, blue, and brown clay-	6	846
Coarse water sand-	-10	856
Red and blue clay-	-15	871
Broken sand and shale with streaks of lime-	-23	894
Red clay and streaks of blue sand and lime-	-15	909
Hard blue sand-	5	914
Brown water sand-	-27	941
Red clay and boulders	-15	956
Packed white sand-	5	961
Red and blue clay with streaks of lime-	-27	988
Soft brown water sand-	-83	1008
Red and blue clay-	-15	1023
Hard blue sand-	2	1025
Gumbo with streaks of sand, lime and shale-	-48	1073
Sticky brown shale-	5	1078
Packed sand-	4	1082
Sand rock-	2	1084
Sticky brown shale-	-20	1104
Tough gumbo and streaks of lime and sand-	-19	1123
Coarse brown water sand-	-65	1188
Red and blue gumbo-	-12	1200
Gumbo and boulders-	-15	1215
Blue and red gumbo-	-13	1228
Red shale-	2	1230
Sandy lime and boulders	2	1232
Sand, shale, and broken lime-	13	1245
Streaky blue sand-	6	1251
Tough, red and blue gumbo	-62	1313
Hard packed gray sand-	5	1318
Red and blue gumbo-	9	1327
Sand rock-	3	1330

Driller's log of well 274--Continued

	Thickness (feet)	Depth (feet)
Gumbo-	-86	1416
Hard packed sand-	3	1419
Sticky red shale-	2	1421
Lime rock-	4	1425
Red and blue gumbo and hard packed sand-	5	1430
Hard packed blue sand-	-17	1447
Red and blue gumbo with streaks of lime and sand-	8	1455
Gray and bluish sand-	26	1481
Red and blue gumbo-	20	1501
Hard packed blue sand-	3	1504
Red and blue sandy gumbo-	-25	1529
Brown sticky shale-	10	1539
Red and blue gumbo-	20	1559
Hard gray sand-	4	1563
Sticky brown shale-	3	1566
Sand rock-	4	1570
Gumbo-	-37	1607
Hard sandy shale and lime-	-29	1636
Red and blue gumbo-	2	1638
Hard sand rock-	5	1643
Red and brown sticky shale-	24	1667
Hard gray sand-	2	1669
Gumbo and streaks of lime	5	1674
Brown sandy shale-	10	1684
Red and blue gumbo with streaks of lime-	15	1699
Brown sandy shale-	8	1708
Tough brown gumbo and streaks of lime-	-27	1734
Sandy shale and brown streaks of lime-	-14	1748
Brown gumbo and lime with streaks of gray sand-	-47	1795
Hard lime rock-	5	1800
Gumbo and streaks of lime-	-20	1820
Hard gray sand-	2	1822
Tough brown gumbo-	-10	1832
Hard gray sand-	2	1834
Tough gumbo with streaks of lime-	-60	1894
Hard brown sand-	3	1897
Tough brown gumbo-	-11	1908
Hard packed sand-	6	1914
Tough brown gumbo-	-20	1934
Sand, brown shale, and lime-	22	1956
Brown gumbo-	-52	2008
Sticky shale and streaks of blue and pink sand-	-81	2089
Chalky lime-	6	2095
Pink and blue gummy shale-	-20	2115
Chalky lime-	3	2118

(Continued on next page)

Table of Drillers' Logs of Wells west of  
the Brazos River, Fort Bend County, Texas

Driller's log of well 274--Continued

	Thickness (feet)	Depth (feet)
Brown and pink gumbo with streaks of lime-	15	2133
Brown and pink sandy shale-	7	2140
Sandy lime-	9	2149
Sand, shale, and lime-	10	2159
Hard lime-	4	2163
Brown and blue gumbo-	9	2172
Sticky shale-	20	2192
Gumbo-	21	2213
Brown, blue, and pink, sticky shale-	25	2238
Brown gumbo and lime-	35	2273
Sandy gumbo with streaks of lime-	7	2280
Pink, blue, and brown, sticky gumbo-	32	2312
Gumbo and lime-	10	2322
Sticky, sandy lime-	8	2330
Red, blue, and brown, sticky shale-	1	2331
Brown shale-	2	2333
Hard shale, sand and lime-	17	2350
Lime rock-	4	2354
Brown, red, and blue shale	24	2378
Tough gumbo-	22	2400
Hard lime-	4	2404
Sandy shale and chalky lime	26	2430
Tough, blue and pink gumbo-	18	2448
Hard sandy lime-	3	2451
Soft lime-	9	2460
Gumbo and lime-	49	2509
TOTAL DEPTH		4510

Driller's log of well 319

Nevarro Oil Co., Hubert Housler lease.  
6 $\frac{1}{2}$  miles northeast of Needville.

Surface clay-	16	16
Sand-	19	35
Sand and clay-	135	170
Sand-	275	445
Sticky clay-	35	480
Sand and clay-	135	615
Sticky shale-	25	640
Sandy clay	48	688
Water sand-	95	783
Sand-	10	793
Gumbo-	64	857
Shale and shell-	68	925
Pink shale and lime	45	970
Sand and boulders	40	1010
Gumbo and lime-	20	1030
Sand and boulders-	97	1127
Gumbo and lime-	75	1202
Sand and boulders-	59	1261
Gumbo-	34	1295

Driller's log of well 319--Continued

	Thickness (feet)	Depth (feet)
Shale and lime-	17	1312
Gumbo and lime-	38	1350
Sandy shale and lime-	62	1412
Gumbo-	12	1424
Sticky shale and lime	29	1453
Shale and lime-	12	1465
Gumbo and lime-	80	1545
Shale and lime-	30	1575
Sandy lime rock	16	1591
Gumbo-	11	1602
Boulders and sandy lime	61	1663
Sandy lime and boulders	15	1678
Shale and boulders-	32	1710
Broken sandy lime rock-	23	1733
Sand rock-	5	1738
Gumbo and lime-	12	1750
Sticky shale-	10	1760
Sandy lime-	15	1775
Sandy lime showing little gas	12	1787
Sticky shale and lime	141	1928
Sand-	22	1950
Gumbo-	53	2003
Shale and lime-	28	2031
Sand-	19	2050
Sand, lime, and boulders	40	2090
Gumbo and lime-	30	2120
Shale and lime-	60	2180
Sticky shale-	23	2203
Lime-	9	2212
Shale and lime-	23	2235
Sticky shale and lime	477	2712
TOTAL DEPTH-		3250

Driller's log of well 329

G. M. Goldsmith, Trustee, E. O. Bartol lease.  
2 $\frac{1}{2}$  miles northeast of Needville.

Surface clay-	35	35
Water sand and boulders	155	190
Blue gumbo-	4	194
Shale and lime-	51	245
Water sand-	75	320
Sandy shale-	65	385
Gumbo-	15	400
Hard shale and lime-	30	430
Water sand-	20	450
Sandy shale-	20	470
Gumbo-	5	475
Water sand-	25	500
Packed sand-	35	535
Gumbo-	15	550
Sandy shale-	8	558
Gumbo-	6	564
Sandy lime-	171	735
Lime rock-	2	737

(Continued on next page)



Table of Drillers' Logs of wells west of  
the Brazos River, Fort Bend County, Texas

Driller's log of well 329--Continued

	Thickness (feet)	Depth (feet)
Sand and shale-	-13	750
Gumbo-	-15	765
Packed sand-	-15	780
Sand and lime-	-10	790
Sandy gumbo-	-10	800
Sandy shale-	-14	814
Gumbo-	5	819
Sand and shale-	-10	829
Shale and lime-	-7	836
Sand rock-	-9	845
Hard sand and lime-	-5	850
Lime rock-	-4	854
Hard sand and lime-	-7	861
Lime rock-	-11	872
Sand and lime-	-5	877
Lime rock-	-6	883
Sand and shale-	-1	884
Hard lime-	-17	901
Sand and boulders-	-15	916
Hard sand rock-	-2	918
Packed sand-	-16	934
Hard sand and lime-	-7	941
Sand and lime rock-	-3	944
Sand and boulders	-11	955
Sand rock-	-3	958
Sandy shale and lime-	-22	980
Gumbo and lime-	-9	989
Sand and shale-	-32	1021
Gumbo and lime-	-10	1031
Hard sand-	-9	1040
Pink gumbo and lime-	-17	1057
Blue and pink shale-	-21	1078
Sandy shale and lime-	-10	1088
Hard sand and lime-	-7	1095
Shale and lime-	-5	1100
Sandy gumbo-	-12	1112
Sandy shale and lime-	-15	1127
Sand, lime, and pink gumbo-	-25	1152
TOTAL DEPTH-	-	1152

Driller's log of well 343  
G. M. Goldsmith, Theo. Rose lease,  
2 1/2 miles east of Needville.

Surface clay-	58	58
Water sand-	47	105
Sandy shale-	5	110
Blue gumbo-	18	128
Blue and brown shale-	12	140
Blue gumbo-	4	144
Sandy shale-	16	160
Blue gumbo-	25	185
Sandy shale-	16	201
Gumbo and lime-	8	209
Sandy shale-	9	218

Driller's log of well 343--Continued

	Thickness (feet)	Depth (feet)
Blue and brown gumbo-	16	234
Dry sand-	12	246
Gumbo-	33	279
Sticky lime and sand-	18	297
Sticky shale-	57	354
Sand and shale-	4	358
Sticky shale-	24	382
Lime, water sand and blue shale-	49	431
Water sand-	58	489
Clay and gumbo-	62	551
Lime and very hard crystal sand streaks with large supply of water-	45	596
Gumbo and lime-	8	604
Sand and gravel-	73	677
Gumbo and lime-	24	701
Hard lime and shale	37	738
Brown shale mixed with small streaks of lime-	25	763
Lime rock-	2	765
Blue and brown sandy shale-	20	785
Sand and water-	65	850
Sand, lime, and boulders-	41	891
Lime rock-	2	893
Sand, lime, and shale-	36	929
Gumbo-	7	936
Sand and lime-	61	997
Pink gumbo-	18	1015
Hard sand and lime-	33	1048
Very hard sand and lime rock	2	1050
Lime and shale-	15	1065
Conglomerate lime rock-	60	1125
Conglomerate-	20	1145

Driller's log of well 351  
Texas Gulf Sulphur Co., J. H. P. Davis  
lease. 7 miles east of Needville.

Sandy clay-	66	66
Sand-	60	126
Shale-	40	166
Sand-	20	186
Shale-	15	201
Sand and gravel-	37	238
Shale-	9	247
Sand and gravel-	15	262
Clay-	2	264
Shale-	91	355
Sand and gravel	15	370
Shale-	4	374
Sandy shale-	35	409
Sandy shale and lime stone-	10	419
Sticky shale-	6	425
Shale-	131	556

Table of Drillers' Logs of wells west of  
the Brazos River, Fort Bend County, Texas

Driller's log of well 357  
Rycade Oil Corporation, J. H. Moore  
lease. 5 $\frac{1}{2}$  miles south of Newville.

	Thickness (feet)	Depth (feet)
Surface - - - - -	5	5
Clay- - - - -	10	15
Sand- - - - -	10	25
Clay- - - - -	20	45
Sand- - - - -	70	115
Shale- - - - -	10	125
Sand, shale, and gravel - -	110	235
Sticky shale- - - - -	30	265
Sand and boulders- - - - -	25	290
Clay- - - - -	20	310
Sand and gravel- - - - -	20	330
Clay- - - - -	10	340
Sand and gravel- - - - -	20	360
Clay- - - - -	30	390
Sand and boulders - - - - -	70	460
Gummy shale- - - - -	40	500
Sand- - - - -	15	515
Sticky shale- - - - -	95	610
Sand and boulders- - - - -	70	680
Shale and lime- - - - -	20	700
Sand and boulders - - - - -	40	740
Sticky shale- - - - -	20	760
Sand and boulders- - - - -	10	770
Sticky shale- - - - -	20	790
Sand, shale, and lime - - - -	48	838
Shale and lime- - - - -	10	848
Sand and boulders- - - - -	30	878
Sand, shale, and lime - - - -	20	898
Sand and boulders- - - - -	42	940
Gumbo and lime- - - - -	42	982
Sand- - - - -	4	986
Sand, shale, and lime - - - -	40	1026
Hard sand and shale- - - - -	4	1030
Sand, shale, and lime - - - -	80	1110
Sticky shale- - - - -	18	1128
Gumbo and lime- - - - -	21	1149
Sand- - - - -	4	1153
Sand, shale and lime- - - - -	22	1175
Gumbo and lime- - - - -	21	1196
Sand- - - - -	2	1198
Sand, shale, and lime- - - - -	4	1202
Gumbo and lime- - - - -	56	1258
Pink gumbo- - - - -	16	1274
Sand- - - - -	16	1290
Gumbo and lime- - - - -	50	1340
Sand- - - - -	15	1355
Sand, shale, and lime- - - - -	28	1383
Hard sand and lime- - - - -	13	1396
Gumbo and lime- - - - -	24	1420
Hard sand, shale, and lime- -	30	1450
Sand and boulders- - - - -	25	1475
Gumbo- - - - -	21	1496
Pink gumbo- - - - -	18	1514

Driller's log of well 357--Continued

	Thickness (feet)	Depth (feet)
Gumbo- - - - -	8	1522
Sand and lime- - - - -	12	1534
Sand, lime, and shale- - - - -	60	1594
Gumbo- - - - -	15	1609
Pink gumbo- - - - -	25	1634
Gumbo- - - - -	45	1679
Gumbo and lime- - - - -	5	1684
Sand, shale, and lime- - - - -	41	1725
Pink gumbo- - - - -	15	1740
Gumbo and lime- - - - -	25	1765
Sand, shale, and lime - - - -	22	1787
Gumbo- - - - -	118	1905
Sand, shale, and lime- - - - -	30	1935
Sand- - - - -	15	1950
Sand, shale, and lime- - - - -	15	1965
TOTAL DEPTH- - - - -		2003

Driller's log of well 412  
Humble Oil and Refining Co., Thompson  
Camp. 4 miles southeast of Booth.

Clay- - - - -	10	10
Sand- - - - -	10	20
Shale- - - - -	25	46
Sand- - - - -	46	112
Shale- - - - -	43	155
Gumbo- - - - -	59	214
Sand- - - - -	33	247
Shale- - - - -	38	285
Gumbo- - - - -	60	345
Shale- - - - -	6	351
Sand- - - - -	10	361
Shale- - - - -	5	366
Sand- - - - -	18	384
Shale- - - - -	36	420
Shale and sand - - - - -	16	436
Hard sand- - - - -	6	442
Water sand- - - - -	12	454
Sand- - - - -	43	497
Shale- - - - -	30	527
TOTAL DEPTH- - - - -		534

Driller's log of well 415  
Vacuum Oil Co, Mrs. Emile Levy lease,  
4 $\frac{1}{2}$  miles east of Booth.

Clay- - - - -	28	28
Sand- - - - -	2	30
Clay- - - - -	50	80
Sand- - - - -	11	91
Red clay- - - - -	29	120
Sand and boulders- - - - -	6	126
Gumbo- - - - -	34	160
Sand- - - - -	44	204
Sand breaks- - - - -	56	260
Gumbo- - - - -	40	300
Shale and boulders- - - - -	40	340

(Continued on next page)

Table of Drillers' Logs of wells west of  
the Brazos River, Fort Bend County, Texas

Driller's log of well 415--Continued	
	Thickness Depth (feet) (feet)
Sand- - - - -	20 360
Sand, shale, and boulders- -	140 500
Coarse sand- - - - -	16 516
Sandy shale and boulders - -	84 600
Gumbo- - - - -	24 624
Sandy shale and boulders- -	186 810
Water sand- - - - -	20 830
Sandy shale and boulders - -	50 880
Gumbo- - - - -	19 899
Corrected lime measurement -	861
Gumbo- - - - -	4 865
Pyrites and lime (gas show)	5 870
Gumbo and boulders- - - - -	143 1013
Shale and boulders- - - - -	11 1024
Gumbo and boulders- - - - -	206 1230
Sand and boulders- - - - -	33 1263
Sand rock- - - - -	1 1264
Gumbo- - - - -	4 1268
Sand rock- - - - -	1 1269
Gumbo- - - - -	51 1320
Sandy shale (cored)- - - - -	9 1329
Sand, shale, and lime- - - - -	3 1332
Gumbo and lime - - - - -	47 1379
Gumbo and boulders- - - - -	12 1491
Gumbo- - - - -	27 1518
Broken lime rock - - - - -	16 1534
Pyrites and lime - - - - -	1 1535
Hard shale and lime - - - - -	14 1549
Gumbo and lime- - - - -	7 1556
Gumbo and boulders- - - - -	32 1588
Gumbo- - - - -	43 1631
Hard gumbo- - - - -	46 1677
Shale and boulders - - - - -	7 1684
Gumbo- - - - -	55 1739
Gumbo- - - - -	26 1765
Sand and boulders- - - - -	43 1808
Gumbo- - - - -	2 1810
Corrected lime measurement -	1763
Gumbo- - - - -	17 1780
Shale- - - - -	20 1800
Sand and boulders- - - - -	22 1822
Hard sand- - - - -	7 1829
Boulders and coarse water sand	10 1839
Shale and boulders- - - - -	47 1886
Gumbo- - - - -	26 1912
Sand and boulders- - - - -	35 1947
Gumbo and boulders - - - - -	23 1970
Sand- - - - -	36 2006
Sticky shale- - - - -	5 2011
Hard sand- - - - -	7 2018
Gumbo- - - - -	35 2053
Sand- - - - -	15 2068
Hard sand- - - - -	20 2088
Gumbo (cored 2068-78 feet)	8 2096

Driller's log of well 415--Continued	
	Thickness Depth (feet) (feet)
<b>Tough gumbo- - - - -</b>	<b>64 2160</b>
Gumbo- - - - -	3 2163
Hard sand- - - - -	4 2167
Brown and pink gumbo and some sand (cored)- - - - -	8 2175
Lime and gumbo- - - - -	26 2201
Hard shale and lime- - - - -	46 2247
Lime and gumbo- - - - -	44 2291
Lime and gumbo- - - - -	23 2314
Hard sandy lime- - - - -	10 2324
Hard sand (cored)- - - - -	22 2346
Gumbo and lime- - - - -	23 2369
Hard gumbo- - - - -	28 2397
Water sand (cored) - - - - -	8 2405
Gumbo- - - - -	99 2504
Water sand - - - - -	8 2512
<b>TOTAL DEPTH- - - - -</b>	<b>2512</b>

Driller's log of well 437  
Rycade Oil Corporation, W. R. Nash lease.  
15 miles south of Booth.

Surface clay- - - - -	100 100
Sand- - - - -	70 170
Shale- - - - -	75 245
Gumbo- - - - -	85 330
Sand- - - - -	60 390
Gumbo- - - - -	40 430
Shale- - - - -	35 465
Gumbo- - - - -	55 520
Sand- - - - -	120 640
Sand and boulders- - - - -	75 715
Gumbo- - - - -	10 725
Sand and boulders- - - - -	35 760
Gumbo- - - - -	60 820
Sand and boulders- - - - -	94 914
Rock- - - - -	6 920
Gumbo- - - - -	6 926
Hard sand and boulders- - -	34 960
Gumbo- - - - -	48 1008
Rock- - - - -	5 1013
Shale- - - - -	3 1016
Rock- - - - -	4 1020
Sand and boulders - - - - -	19 1039
Rock- - - - -	4 1043
Hard sand and boulders- - -	37 1080
Gumbo- - - - -	42 1122
Sand rock- - - - -	4 1126
Sand and boulders- - - - -	3 1129
Sand- - - - -	5 1134
Gumbo- - - - -	62 1196
Cored 1130-1134	
Sandy lime- - - - -	17 1213
Cored 1197-1203 water	
Sand- - - - -	31 1244

(Continued on next page)

Table of Drillers' Logs of wells west of  
the Brazos River, Fort Bend County, Texas

Driller's log of well 437--Continued		Thickness	Depth
	(feet)	(feet)	
Rock- - - - -	7	1251	
Sand- - - - -	3	1254	
Cored 1251-1254			
Sand rock- - - - -	2	1256	
Gumbo and lime- - - - -	114	1370	
Cored 1372-1377			
Hard shale- - - - -	30	1400	
Cored 1408-1411			
Lime- - - - -	4	1404	
Sand, shale and lime- - - - -	2	1406	
Gumbo and lime- - - - -	37	1443	
Rock- - - - -	10	1453	
Gumbo and lime- - - - -	80	1533	
Sandy shale- - - - -	17	1550	
Cored 1535-1541			
Gumbo- - - - -	120	1670	
Sticky shale- - - - -	3	1673	
Gumbo- - - - -	35	1708	
Cored 1673-1676, water 1713-1719.			
Sand- - - - -	20	1728	
Gumbo- - - - -	32	1760	
Sandy shale- - - - -	50	1810	
Cored 1770-1775			
Sticky shale- - - - -	50	1860	
Gumbo and lime- - - - -	15	1875	
Sand- - - - -	15	1890	
Cored 1880-1886			
Lime rock- - - - -	2	1892	
Gumbo and lime- - - - -	43	1935	
Sand and shale- - - - -	9	1944	
Cored 1934-1938			
Sand and boulders- - - - -	51	1995	
Gumbo- - - - -	45	2040	
Sandy shale- - - - -	3	2043	
Hard sand and lime with boulders- - - - -			
	50	2093	
Cored 2043-2050			
Gumbo- - - - -	21	2114	
Sand and shale- - - - -	37	2151	
Cored 2117-2120			
Gumbo- - - - -	11	2162	
Gumbo, lime, and boulders- - - - -	68	2230	
Gumbo and lime- - - - -	75	2305	
Shale- - - - -	9	2314	
Sticky shale and lime- - - - -	80	2394	
Cored 2310-2314, 2399-2404, 2449-2454.			
Sand and shale- - - - -	30	2424	
Gumbo- - - - -	20	2444	
Sand and boulders- - - - -	34	2478	
Gumbo- - - - -	26	2504	
TOTAL DEPTH- - - - -		4900	

Driller's log of well 438		Thickness	Depth
Rycade Oil Corporation., Fritz Meir lease. 15 miles south of Booth.		(feet)	(feet)
Surface clay- - - - -	25	25	
Sand- - - - -	10	35	
Clay- - - - -	30	65	
Sand- - - - -	21	86	
Clay- - - - -	34	120	
Sand and gravel- - - - -	70	190	
Sticky shale- - - - -	40	230	
Sand and gravel- - - - -	60	290	
Clay- - - - -	15	305	
Sand and gravel- - - - -	15	320	
Clay- - - - -	44	364	
Sandy gravel- - - - -	55	419	
Sticky shale- - - - -	51	470	
Sand and boulders- - - - -	75	545	
Gumbo and lime- - - - -	30	575	
Sand and boulders- - - - -	105	680	
Gumbo and lime- - - - -	45	725	
Sand, shale, and lime- - - - -	55	780	
Gumbo and lime- - - - -	40	820	
Hard sand- - - - -	4	824	
Sand, shale, and lime- - - - -	81	905	
Sand and boulders- - - - -	53	958	
Hard sand and lime- - - - -	5	963	
Sand, shale and lime- - - - -	42	1005	
Hard sand and lime- - - - -	61	1066	
Cored at 1040 NS			
Hard sand rock- - - - -	4	1070	
Gumbo and lime- - - - -	40	1110	
Sand- - - - -	5	1115	
Hard sand and lime- - - - -	7	1122	
Cored at 1115 & 1119			
Gumbo and lime- - - - -	35	1157	
Hard sand and lime- - - - -	62	1219	
Ran roller bit. Cored at 1164-1181.			
Tough blue gumbo- - - - -	10	1229	
Gumbo and lime- - - - -	7	1236	
Hard sand and lime- - - - -	5	1241	
Lime- - - - -	5	1246	
Crystallized sand and lime--	7	1253	
Cored at 1246			
Soft sand- - - - -	4	1257	
Anhydrite and lime- - - - -	2	1259	
Cored at 1257			
Anhydrite, lime, and sand -	17	1276	
Cored at 1269			
Anhydrite, and crystallized lime- - - - -	34	1320	
Crystallized lime- - - - -	5	1325	
Cored 1305-1325			
Hard lime- - - - -	10	1335	
Hard sandy lime - - - - -	1	1336	
Cored 1335. Cored 1336.			

(Continued on next page)

Table of Drillers' Logs of wells west of the Brazos River, Fort Bend County, Texas

Driller's log of well 438--Continued

		Thickness	Depth			Thickness	Depth
		(feet)	(feet)			(feet)	(feet)
Hard sand and lime-	- - - -	11	1347	Anhydrite and lime-	- - - -	50	1578
Anhydrite and lime-	- - - -	15	1362	Cored at 1548, 1568, 1578			
Cored 1347				Anhydrite, lime and sulphur	-11		1589
Anhydrite-	- - - -	7	1369	Cored at 1584			
Cored at 1366				Anhydrite and lime-	- - - -	5	1594
Anhydrite and lime-	- - - -	30	1399	Cored at 1589-1594.			
Cored at 1386.				Anhydrite, lime and sulphur	-38		1632
Anhydrite and sand-	- - - -	24	1423	Cored at 1599-1604, 1610-1616,			
Cored at 1404.				1622-1632.			
Anhydrite and lime-	- - - -	20	1443	Anhydrite and sulphur-	- - - -	6	1638
Cored at 1423.				Cored 1636.			
Anhydrite and crystal lime-	5	1448		Calcite-	- - - -	9	1647
Cored at 1443, 1463, 1488-1508.				Cored 1639-1642.			
Anhydrite and lime-	- - - -	60	1508	Anhydrite and sand-	- - - -	7	1654
Cored at 1508.				Cored at 1649.			
Anhydrite and crystal lime	20	1528		Anhydrite-	- - - -	58	1712
Cored 1528				Cored 1661-1686			
				TOTAL DEPTH-	- - - -		1712

Logs of test wells drilled by W.P.A. labor west of the Brazos River in  
Fort Bend County, Texas.

Samples examined and classified by G. A. Elledge, Project Superintendent.

Wells drilled December 12, 1935 to May 30, 1936.

Well 2

Highway 36 right of way near northwest corner of P. Bland 100 acre tract, Shelby-Frazier and McCormick Survey, 3-1/4 miles west of Orchard.

	Thickness (feet)	Depth (feet)
Black surface soil- - - - -	5	5
Red clay- - - - -	5	10
Red sandy clay- - - - -	7	17
Brown sand- - - - -	9	26
White sand, caving- - - - -	8	34
No water sample collected.		

Well 3

Near center of north line of H. H. Aylor Estate 138.3 acre tract, Gail Borden Jr. Survey, 1-3/4 miles west of Orchard.

Black surface soil- - - - -	4	4
Red clay- - - - -	5	9
Red sandy clay- - - - -	2	11
Brown sand- - - - -	15	26
Red sandy clay- - - - -	1	27
Brown sand- - - - -	5	32
Sandy clay- - - - -	1	33
Red clay- - - - -	2	35
Brown sand- - - - -	2	37
No water sample collected.		

Well 4

Center of north line of H. H. Aylor Estate 49.95 acre tract, Gail Borden Jr. Survey, 1 mile west of Orchard.

Sandy soil- - - - -	3	3
Yellow clay - - - - -	3	6
Gray clay - - - - -	2	8
Red, and gray clay- - - - -	1	9
White sandy clay- - - - -	6	15
Ball clay with white sand -	9	24
Brown sand- - - - -	3	27
Red clay- - - - -	1	28
Red sandy clay- - - - -	2	30
Brown sand- - - - -	2	32
Yellow sand - - - - -	1	33
Brown sand- - - - -	7	40
Yellow sand - - - - -	1	41
Brown sand- - - - -	9	50
Sand, caving- - - - -	1	51
No water sample collected.		

Well 7

Side of public road near southwest corner of John G. Losack 12.66 acre tract, Gail Borden Jr. Survey, 1/4 mile south of Orchard.

	Thickness (feet)	Depth (feet)
Black sandy soil- - - - -	3	3
White sand- - - - -	1	4
Yellow clay - - - - -	2	6
Red sandy clay- - - - -	4	10
Red sand- - - - -	1	11
Yellow sand - - - - -	8	19
White sand- - - - -	3	22
Yellow sand - - - - -	3	25
Sand- - - - -	1	26
No water sample collected.		

Well 8

Southeast corner of H. H. Aylor 13.2 acre tract, Gail Borden Jr. Survey, 1/4 mile east of Orchard.

Black surface soil- - - - -	3	3
Blue clay- - - - -	2	5
Red clay - - - - -	5	10
Brown sand- - - - -	11	21
Red clay- - - - -	3	24
Brown sand- - - - -	6	30
White sand- - - - -	3	33
Brown sand- - - - -	7	40
Sand- - - - -	1	41
No water sample collected.		

Well 9

Side of County road near southeast corner Louis Sanders 150 acre tract, Gail Borden Jr. Survey, 1/2 mile north of Orchard.

Black sandy surface- - -	3	3
Gray clay- - - - -	2	5
Red clay - - - - -	3	8
Red sand - - - - -	15	23
Red clay - - - - -	2	25
White sand - - - - -	9	34
No water sample collected.		

Well 10

Center north 1/2 mile west line of Ino. Hackbarth 220 acre tract, Gail Borden Jr. Survey, 1 1/4 miles north of Orchard.

Black sandy soil- - - - -	4	4
Red clay- - - - -	3	7
Red sand- - - - -	2	9
White sand- - - - -	20	29
Sand- - - - -	1	30
No water sample collected.		

Logs of test wells west of the Brazos River in Fort Bend County--Continued

Well 12

Public roadside near center of south  $\frac{1}{2}$  of east line of G. H. Wooster 108.4 acre tract, Gail Borden Jr. Survey, 1-3/4 miles north of Orchard.

	Thickness (feet)	Depth (feet)
Black soil- - - - -	5	5
Gray clay - - - - -	14	19
Yellow sand - - - - -	1	20
White sand- - - - -	3	23
Brown sand- - - - -	3	26
Red sandy clay- - - - -	1	27
Red clay- - - - -	1	28
Brown sand- - - - -	8	36
Red sandy clay- - - - -	3	39
Red clay- - - - -	2	41
Brown sand- - - - -	1	42
Ball clay and brown sand- -	4	46
No water sample collected.		

Well 14

County roadside, 1,000 feet south of Brazos River near east line of G. A. Wooster 108.4 acre tract, Gail Borden Jr. Survey,  $2\frac{1}{2}$  miles north of Orchard.

Black surface soil- - - - -	6	6
Red clay- - - - -	4	10
White sandy clay- - - - -	6	16
White sand- - - - -	16	32
Sand- - - - -	1	33
No water sample collected.		

Well 17

Northeast corner of Litta M. Little 257.63 acre tract, B.B.B. and C. R.R.Co. Survey, 5 miles east of Orchard.

Black soil- - - - -	5	5
Red clay and gravel - - - -	3	8
Red clay- - - - -	2	10
Red sand- - - - -	2	12
White sand- - - - -	8	20
Sand- - - - -	1	21
No water sample collected.		

Well 18

$\frac{1}{4}$  mile northeast of southwest corner of John M. Moore 3,572.61 acre tract, Nancy Spencer Survey, 3-3/4 miles east of Orchard.

Black surface soil- - - - -	6	6
Light red clay- - - - -	2	8
Red clay- - - - -	2	10
Red sand- - - - -	9	19
Sand- - - - -	1	20
No water sample collected.		

Well 19

Center of north line of John M. Moore Jr. 423.81 acre tract, Yandell Ferris Survey, 2-3/4 miles east of Orchard.

	Thickness (feet)	Depth (feet)
Black soil- - - - -	6	6
Gray clay - - - - -	1	7
Red clay- - - - -	6	13
Gray clay - - - - -	1	14
Brown sand- - - - -	2	16
White sand- - - - -	3	19
Sand, caving- - - - -	1	20
No water sample collected		

Well 20

25 feet south of highway 36, German Emig.Co. Survey, 2 miles east of Orchard.

Black surface soil- - - - -	6	6
Red clay- - - - -	1	7
Red sandy clay- - - - -	1	8
Red clay- - - - -	19	27
Blue gumbo clay - - - - -	1	28
Red clay- - - - -	2	30
Brown sand- - - - -	3	33
Hard gravel and sand, caving	1	34
No water sample collected.		

Well 21

100 feet south of highway 36, L. Burknapp Survey, 3/4 mile east of Orchard.

Black soil- - - - -	4	4
Gray clay- - - - -	1	5
Red sand- - - - -	1	6
Yellow sand - - - - -	1	7
Red and white clay- - - - -	5	12
Yellow sand- - - - -	1	13
White sand- - - - -	7	20
Yellow sand - - - - -	1	21
Red sandy clay- - - - -	1	22
Red sand- - - - -	4	26
Red clay- - - - -	1	27
Brown sand- - - - -	6	33
Rock- - - - -	$\frac{1}{2}$	$33\frac{1}{2}$
Red sandy clay- - - - -	$\frac{1}{2}$	34
Red sand- - - - -	3	37
Red clay- - - - -	1	38
Brown sand- - - - -	1	39
Sand- - - - -	1	40
No water sample collected.		

Well 22

Side of public road on west line of Jno. M. Moore Estate 640 acre tract, Heirs of David Scott Survey,  $1\frac{1}{2}$  miles southwest of Orchard.

Black surface- - - - -	3	3
------------------------	---	---

Logs of test wells west of the Brazos River in Fort Bend County--Continued

Well 22--Continued

	Thickness (feet)	Depth (feet)
Brown clay- - - - -	3	6
Gray clay - - - - -	2	8
Brown sand- - - - -	2	10
White sand- - - - -	13	23
Sand- - - - -	1	24
No water sample collected.		

Well 23

Side of public road near northwest corner on west line of Mark Smith Survey, 2 1/2 miles southwest of Orchard.

Black sandy soil- - - - -	5	5
Red clay- - - - -	8	13
Yellow sand - - - - -	2	15
Sandy clay- - - - -	2	17
Red clay- - - - -	3	20
Yellow sand - - - - -	2	22
Brown sand- - - - -	6	28
White sand- - - - -	4	32
Sand- - - - -	1	33
No water sample collected.		

Well 24

Side of public road near southeast corner of Leo Duck 300 acre tract, Charles Baird Survey, 3 miles south of Orchard.

Black surface- - - - -	5	5
Gray clay- - - - -	1	6
Red clay - - - - -	9	15
Brown sand- - - - -	10	25
Sand- - - - -	1	26
No water sample collected.		

Well 101

Near center of north line of Farmers Gin Co. 68 acre tract, Andrew Northington Survey, 8 miles west of Beasley.

Black soil- - - - -	6	6
Red clay- - - - -	2	8
Red sandy clay- - - - -	3	11
White sand- - - - -	4	15
Red clay- - - - -	1	16
Red sand- - - - -	6	22
Red clay- - - - -	10	32
Sand, caving- - - - -	1	33
No water sample collected.		

Well 102

25 feet south of highway 3, 13 miles west of intersection of highway 3 and 12, Andrew Northington Survey, 7 miles west of Beasley.

Black surface soil- - - - -	6	6
Red clay- - - - -	13	19
Blue gummy clay - - - - -	2	21

Well 102--Continued

	Thickness (feet)	Depth (feet)
Red clay- - - - -	9	30
Sand- - - - -	1	31
No water sample collected.		

Well 103

100 feet south of highway 3, 12 1/4 miles west of intersection of highways 3 and 120, Andrew Northington Survey, 7 miles west of Beasley.

Black soil- - - - -	6	6
Red clay- - - - -	29	35
Sand, caving- - - - -	1	36
No water sample collected.		

Well 104

Northwest corner of E. Yygryp 100 acre tract, Andrew Northington Survey, 6 1/2 miles northwest of Beasley.

Black soil- - - - -	6	6
Red clay- - - - -	22	28
Sand- - - - -	1	29
No water sample collected.		

Well 105

Northwest corner of C.N. Williamson 105 acre tract, Andrew Northington Survey, 6 miles northwest of Beasley.

Black surface soil- - - - -	6	6
Red clay- - - - -	2	8
Red sandy clay- - - - -	7	15
Red clay- - - - -	16	31
Sand, caving- - - - -	1	32
No water sample collected.		

Well 107

Northwest corner of A. W. Wenzel 84 acre tract, Andrew Northington Survey, 5 1/2 miles northwest of Beasley.

Black surface soil- - - - -	7	7
Red clay- - - - -	11	18
Red sand- - - - -	1	19
Red and white clay- - - - -	2	21
Red sand- - - - -	2	23
Sand, caving- - - - -	2	25
No water sample collected.		

Well 108

Near center of north line of E. Reimer 76.9 acre tract, Andrew Northington Survey, 5 miles northwest of Beasley.

Black soil- - - - -	4	4
Brown clay with gravel- - - - -	6	10
Brown sand- - - - -	9	19
Sand, caving- - - - -	2	21
No water sample collected.		



Logs of test wells west of the Brazos River in Fort Bend County--Continued

Well 109

Side of public road near center of south 1/2 of east line of J. E. and Geo. Gibbs 696.5 acre tract, Charles Baird Survey, 3-3/4 miles south of Orchard.

	Thickness (feet)	Depth (feet)
Black surface soil- - - - -	6	6
Red clay- - - - -	2	8
Brown sand - - - - -	10	18
Red sandy clay - - - - -	8	26
Sand- - - - -	1	27
No water sample collected.		

Well 112

Near northwest corner W.C. and R. L. Buls 159.37 acre tract, H. C. Taylor Survey, 4-3/4 miles northwest of Beasley.

Black surface soil- - - - -	6	6
Red clay- - - - -	2	8
Red sandy clay- - - - -	2	10
Red sand- - - - -	3	13
White sand- - - - -	7	20
Sand, caving- - - - -	1	21
No water sample collected.		

Well 115

Center north line J.W. Koehler 98 acre tract, B.B.B. and C. R.R. Co. Survey, 4 1/2 miles northwest of Beasley.

Black soil- - - - -	5	5
Clay and gravel- - - - -	4	9
Brown sand- - - - -	10	19
Sand- - - - -	2	21
No water sample collected.		

Well 116

Center north line J.A. Guntle 115.5 acre tract, B.B.B. and C. R.R. Co. Survey, 4 miles northwest of Beasley.

Black surface soil- - - - -	6	6
Red clay- - - - -	2	8
Red sandy clay- - - - -	2	10
Red clay- - - - -	8	18
Red sandy clay- - - - -	3	21
Red clay- - - - -	3	24
Red sandy clay- - - - -	4	28
Red clay- - - - -	10	38
Sand, caving- - - - -	1	39
No water sample collected.		

Well 117

West of center of north line of J. A. Guntle 88.78 acre tract, S. A. and M. G. Survey, 3-3/4 miles northwest of Beasley.

Black soil- - - - -	6	6
Red clay- - - - -	5	11
Red sand- - - - -	3	14

Well 117--Continued

	Thickness (feet)	Depth (feet)
Red clay- - - - -	30	44
Sand- - - - -	1	45
Struck water at 45 feet.		
No water sample collected.		

Well 118

Northwest corner of Needville, S. B. and T. Co. 111 acre tract, B.B.B. and C. R.R. Co. Survey, 3 1/2 miles northwest of Beasley

Black surface soil- - - - -	6	6
Red clay- - - - -	5	11
Red sand- - - - -	3	14
Red clay- - - - -	10	24
Red sandy clay- - - - -	2	26
Red clay- - - - -	6	32
Sand, caving- - - - -	1	33
No water sample collected.		

Well 120

Near center of west 1/2 of north line of O. Warneke 99.4 acre tract, B.B.B. and C. R. R. Co. Survey, 3 1/2 miles northwest of Beasley.

Black sand- - - - -	5	5
Brown clay- - - - -	6	11
Brown sand- - - - -	4	15
White clay- - - - -	1	16
Brown sand- - - - -	8	24
No water sample collected.		

Well 121

Northeast corner of E.B. Knolle 102.1 acre tract, B.B.B. and C. R. R. Co. Survey, 3 1/2 miles north of Beasley.

Sandy soil- - - - -	5	5
White sandy clay - - - - -	5	10
White sand- - - - -	12	22
No water sample collected.		

Well 123

Northwest corner of Wm. A. Wenzel 135.25 acre tract, L. E. Cross Survey, 3 1/4 miles north of Beasley.

Sandy soil- - - - -	2	2
Sandy clay- - - - -	3	5
Red clay- - - - -	3	8
White sand- - - - -	14	22
No water sample collected.		

Well 125

Northeast corner of Wm. A. Wenzel 135.25 acre tract, L. E. Cross Survey, 3 1/4 miles north of Beasley.

Black sandy soil- - - - -	6	6
Red clay- - - - -	4	10

(Continued next page)

Logs of test wells west of the Brazos River in Fort Bend County--Continued

Well 125--Continued

	Thickness (feet)	Depth (feet)
Red sandy clay- - - - -	2	12
White sand- - - - -	2	14
Brown sand- - - - -	2	16
White sand- - - - -	6	22
No water sample collected.		

Well 128

Northeast corner of E. R. Knolle 78.7 acre tract, B.B.B. and C. R. R. Co. Survey,  $3\frac{1}{2}$  miles north of Beasley.

Yellow clay- - - - -	3	3
Blue clay- - - - -	3	6
Red clay- - - - -	2	8
Sandy gravel- - - - -	2	10
White sand- - - - -	14	24
No water sample collected.		

Well 131

Northwest corner of F. J. Mikulancak west 78.7 acre tract, B.B.B. and C. R. R. Co. Survey,  $3\frac{3}{4}$  miles northeast of Beasley.

Black surface soil- - - -	7	7
White sandy clay - - - -	3	10
Brown sand- - - - -	4	14
White sand - - - - -	10	24
No water sample collected.		

Well 135

North corner of A. E. Pleak 87.1 acre tract, S. A. and M. G. R. R. Co. Survey,  $1\frac{1}{2}$  miles northeast of Beasley.

Black soil- - - - -	5	5
Red clay- - - - -	4	9
Red sand- - - - -	6	15
Brown sand- - - - -	1	16
Red sandy clay- - - - -	4	20
Red sand- - - - -	3	23
Sand, caving- - - - -	1	24
No water sample collected.		

Well 137

Near center of west  $\frac{1}{2}$  of north line of H. C. Hodde and G. Glissman 41.5 acre tract, I. and G. N. R. R. Co. Survey,  $\frac{3}{4}$  mile northeast of Beasley.

Black surface soil- - - -	3	3
Dark brown clay- - - - -	2	5
Red crumbly clay- - - - -	2	7
Red sandy clay- - - - -	2	9
White sand- - - - -	10	19
Sand, caving- - - - -	1	20
No water sample collected.		

Well 139

Near center of town of Beasley, 100 feet east of highway 12.

	Thickness (feet)	Depth (feet)
Black soil- - - - -	6	6
Gray clay - - - - -	2	8
Red clay- - - - -	16	24
Red and blue clay - - -	2	26
Red sandy clay- - - - -	3	29
Sand- - - - -	1	30
Struck water at 30 feet. Caving below 30 feet. No water sample collected.		

Well 141

Near northeast corner of Stepe Lunds tract, center of south  $\frac{1}{4}$  of east  $\frac{1}{4}$  of section 3 of S. A. and M. G. R. R. Co. Survey,  $\frac{1}{2}$  mile southwest of Beasley.

Black soil- - - - -	4	4
Gray clay - - - - -	1	5
Red clay and gravel - -	3	8
Red sandy clay- - - - -	7	15
Red sand- - - - -	2	17
Red clay	16	33
Sand- - - - -	1	34
Struck water at 33 feet. Caving at 34 feet. No water sample collected.		

Well 146

Center northwest line of R. Wade 60 acre tract, S. N. Cross section 4, S. A. and N. G. R. R. Co. Survey,  $1\frac{1}{2}$  miles southwest of Beasley.

Black surface soil- - - -	5	5
Blue gummy clay- - - - -	2	7
Red crumbly clay - - - -	3	10
Brown sandy clay - - - -	3	13
Brown sand- - - - -	8	21
Sand, dry, caving- - - -	1	22
No water sample collected.		

Well 148

Northeast corner Texas Company 585 acre tract, B.B.B. and C. R. R. #309 Survey,  $2\frac{1}{2}$  miles southwest of Beasley.

Sandy surface soil- - - -	3	3
Grayish clay- - - - -	2	5
Red crumbly clay- - - - -	3	8
Red clay- - - - -	4	12
Red sand- - - - -	2	14
White gravel clay - - - -	1	15
Red sand- - - - -	4	19
Sand, caving- - - - -	1	20
No water sample collected.		

Logs of test wells west of the Brazos River in Fort Bend County--Continued

Well 151

On public road near center of northeast line of P.H. Johnson 137 acre tract, G. Cole Survey, 2 $\frac{1}{2}$  miles west of Beasley.

	Thickness (feet)	Depth (feet)
Black sandy soil- - - - -	5	5
Red sand- - - - -	5	10
White sand- - - - -	2	12
Red sand- - - - -	7	19
Red clay- - - - -	1	20
Red sand- - - - -	1	21
Sand- - - - -	1	22

No water sample collected.

Well 153

West corner W. M. Andrus Estate 84.43 acre tract, Gabriel Cole Survey, 3 miles southwest of Beasley.

Black sand- - - - -	2	2
Red clay and gravel - - - -	2	4
Red sand- - - - -	1	5
Brown clay and gravel - - - -	2	7
Brown sand- - - - -	1	8
Yellow sand - - - - -	4	12
Brown sand- - - - -	7	19
Sand, caving- - - - -	1	20

No water sample collected.

Well 159

West corner R. H. Darst et al. 149 acre tract, Joseph H. McCormick Survey, 5 $\frac{1}{2}$  miles west of Beasley.

Black soil- - - - -	4	4
Red clay- - - - -	14	18
Gray clay - - - - -	4	22
Red clay- - - - -	13	35

No water sample collected.

Well 162

North corner of J. Wright 25 acre tract, Isaac McGary Survey, 6 $\frac{1}{2}$  miles southwest of Beasley.

Black sandy soil- - - - -	3	3
Gray clay- - - - -	1	4
Red clay - - - - -	5	9
White clay- - - - -	7	16
Red clay- - - - -	2	18
Blue clay - - - - -	1	19
Red clay - - - - -	8	27
Sand, caving - - - - -	1	28

Struck water at 24 feet.

Water level, 20 feet below top of ground, 1 hour after hole completed.

No water sample collected.

Well 164

Rolling country, center southeast line A. Wright tract, Isaac McGary Survey, 5 $\frac{1}{2}$  miles southwest of Beasley.

	Thickness (feet)	Depth (feet)
Black soil- - - - -	5	5
Brown clay- - - - -	3	8
Gray clay - - - - -	4	12
Red clay- - - - -	8	20
White clay- - - - -	3	23
Sand, caving- - - - -	1	24

Struck water at 24 feet.

Water level, 20 feet below top of ground,  $\frac{1}{2}$  hour after hole completed.

No water sample collected.

Well 167

Near center northwest line W. T. McFarlane 63.6 acre tract, Isaac McGary Survey, 4 $\frac{1}{2}$  miles southwest of Beasley.

Black surface soil- - - - -	6	6
Light red clay- - - - -	1	7
Red clay- - - - -	8	15
Yellowish clay- - - - -	5	20
Light red clay- - - - -	2	22
Red clay- - - - -	21	43
Sand, caving- - - - -	1	44

Struck water at 30 feet.

No water sample collected.

Well 170

Center southeast line of R. H. Darst 50 acre tract, Elizabeth Powell Survey, 6 miles southwest of Beasley.

Surface sand- - - - -	4	4
White sand and gravel - - - -	2	6
White clay- - - - -	6	12
Red clay- - - - -	2	14
White clay- - - - -	2	16
Sand- - - - -	1	17

Struck water 17 feet.

Water level, 7 feet below top of ground, 1 hour after hole completed.

Water sample collected.

Well 179

County road, near south corner of Meyer and Schawe 100 acre, block 45, Heirs of Wm. Garnett #1 Survey, 10 miles south of Beasley.

Black surface soil - - - -	5	5
Red clay- - - - -	6	11
Red sand- - - - -	10	21
Joint clay- - - - -	5	26

Water level, 21 feet below top of ground, 4 hours after hole completed.

Water sample collected.

Logs of test wells west of the Brazos River in Fort Bend County--Continued

Well 180

County road near south corner of Texas Land Company 96.19 acre tract, block 14 of Simon Miller League #2, 12 $\frac{1}{2}$  miles south of Beasley.

	Thickness (feet)	Depth (feet)
Black surface soil- - - - -	5	5
Red clay- - - - -	6	11
Red sand- - - - -	7	18
Red sandy clay- - - - -	5	23
Sand- - - - -	1	24
Struck water at 24 feet.		
Water level, 24 feet below top of ground, 8 hours after hole completed.		
Water sample collected.		

Well 201

3 $\frac{1}{2}$  miles west of intersection of highways 3 and 36 on highway 36, Y. Ferris Survey, 6 $\frac{1}{2}$  miles west of Richmond.

Black surface soil- - - - -	6	6
Light red clay- - - - -	2	8
Red clay- - - - -	2	10
Grayish clay- - - - -	5	15
White clay- - - - -	5	20
White sand- - - - -	5	25
White sandy clay- - - - -	1	26
Brown sandy clay- - - - -	1	27
White sandy clay- - - - -	3	30
Red clay- - - - -	1	31
Red sandy clay- - - - -	2	33
White sand- - - - -	2	35
Sand, caving- - - - -	1	36
No water sample collected.		

Well 202

Near center of east half of north line of west half of Ivy M. Morrison 277 acre tract, B.B.B. and C. R. R.Co. Survey, 5 $\frac{1}{2}$  miles west of Richmond.

Black soil- - - - -	4	4
Yellow clay - - - - -	3	7
Red clay- - - - -	5	12
White clay- - - - -	4	16
Red clay- - - - -	4	20
Red sand- - - - -	4	24
Sand, caving- - - - -	1	25
No water sample collected.		

Well 203

Northeast corner of the Abe Robinowitz 105.35 acre tract, Henry Scott Survey, 4-3/4 miles west of Richmond.

Black surface soil- - - - -	6	6
Light red clay- - - - -	2	8
Red clay- - - - -	5	13
Blue gumbo clay - - - - -	6	19

Well 203--Continued

	Thickness (feet)	Depth (feet)
Red clay- - - - -	7	26
Sand- - - - -	1	27
No water sample collected.		

Well 204

$\frac{1}{2}$  mile west of intersection of highways 36 and 3, on highway 36, Henry Scott Survey, 3 $\frac{1}{2}$  miles west of Richmond.

Black sand- - - - -	5	5
Sandy clay- - - - -	2	7
Red clay- - - - -	1	8
Brown clay and gravel - - - - -	2	10
Red clay- - - - -	1	11
Gray clay - - - - -	10	21
Red clay- - - - -	2	23
Gray clay - - - - -	4	27
Brown sand- - - - -	1	28
White sandy clay- - - - -	1	29
Red sand- - - - -	2	31
White sand- - - - -	2	33
Sand- - - - -	1	34
No water sample collected.		

Well 206

Northwest corner G. C. Baker 180.6 acre tract, Henry Scott Survey, 3 $\frac{1}{2}$  miles southwest of Richmond.

Black soil- - - - -	4	4
Red clay- - - - -	6	10
White clay- - - - -	6	16
Red clay- - - - -	8	24
Sandy clay- - - - -	3	27
Water level, 20 feet below top of ground, - hours after hole completed.		
No water sample collected.		

Well 208

Near northeast corner of Will Tieman 20 acre tract, Henry Scott Survey, 4 miles west of Richmond.

Black surface soil- - - - -	8	8
Brown sandy clay- - - - -	8	16
White sand- - - - -	6	22
Sand- - - - -	2	24
No water sample collected.		

Well 212

On highway 3, 1 $\frac{1}{2}$  miles west of intersection of highways 3 and 12, Henry Scott Survey, 4-3/4 miles west of Richmond.

Black surface soil- - - - -	6	6
Red clay- - - - -	7	13
White gummy clay- - - - -	1	14

(Continued next page)

Logs of test wells west of the Brazos River in Fort Bend County--Continued

Well 212--Continued

	Thickness (feet)	Depth (feet)
Red clay- - - - -	5	19
White crumbly clay- - - - -	2	21
White sand- - - - -	3	24
Sand with sulphur - - - - -	2	26
Red crumbly clay- - - - -	1	27
White sand- - - - -	1	28
No water sample collected.		

Well 214

Northeast corner Elizabeth Besgrave 160 acre tract, S. P. R. R. Co. Survey, 5 $\frac{1}{2}$  miles west of Richmond.

Black soil- - - - -	3	3
Yellow clay - - - - -	4	7
Gravel and clay - - - - -	3	10
Sand- - - - -	12	22
No water sample collected.		

Well 219

Near center west  $\frac{1}{2}$  of north line of T. Hillyer 200 acre tract, S. P. R. R. Co. Survey, 6 $\frac{1}{2}$  miles west of Richmond.

Black surface soil- - - - -	7	7
Red clay- - - - -	15	22
White clay- - - - -	2	24
White sand- - - - -	1	25
No water sample collected.		

Well 222

Northeast corner of A. E. Pleak 25 acre tract, S. A. and M. G. R. R. Co. Survey, 8 miles southwest of Richmond.

Black surface soil- - - - -	6	6
Red clay- - - - -	9	15
Red sand- - - - -	5	20
Red sandy clay- - - - -	2	22
Red sand- - - - -	2	24
Sand, caving- - - - -	1	25
No water sample collected.		

Well 227

Northwest corner of M. Dzeranowski 143 acre tract, Emma Meyer block of section 8 of H. and T. C. R. R. Company Survey, 7 miles southwest of Richmond.

Black soil- - - - -	5	5
Red clay and gravel - - - - -	4	9
White sand- - - - -	10	19
Sand, caving- - - - -	1	20
No water sample collected.		

Well 230

Center of northwest line of F. Stripka 120 acre tract, section 12 of H. and T. C. R. R. Company Survey, 6 miles southwest of Richmond.

	Thickness (feet)	Depth (feet)
Black surface soil- - - - -	5	5
Red clay- - - - -	2	7
Red sandy clay- - - - -	2	9
Red sand- - - - -	8	17
White sand- - - - -	1	18
Red sand- - - - -	1	19
Sand, caving- - - - -	1	20
No water sample collected.		

Well 232

100 feet east of highway 12, 2 miles southwest of intersection of highways 12 and 3, Henry Scott Survey, 5 miles southwest of Richmond.

Black soil- - - - -	4	4
Gray clay- - - - -	2	6
Red clay and gravel - - - - -	2	8
Red sand- - - - -	3	11
White clay and gravel - - - - -	1	12
Red sand- - - - -	4	16
Yellow sand - - - - -	1	17
White sand - - - - -	2	19
Sand, caving- - - - -	3	22
No water sample collected.		

Well 235

Near center of J. M. Staton tract, Henry Scott Survey, 4 $\frac{1}{2}$  miles southwest of Richmond.

Black surface soil- - - - -	6	6
Red clay- - - - -	4	10
Red sand - - - - -	5	15
White sand - - - - -	3	18
Brown sand - - - - -	10	28
Sand, caving - - - - -	1	29
No water sample collected.		

Well 238

Center north  $\frac{1}{2}$ , 21.2 acre tract in Rosenberg Farms addition, Henry Scott Survey, 3-3/4 miles southwest of Richmond.

Black surface soil- - - - -	6	6
Red clay- - - - -	4	10
Red sand- - - - -	1	11
Red clay and gravel - - - - -	4	15
Red sand- - - - -	3	18
Red clay- - - - -	2	20
Red sand- - - - -	1	21
Red clay- - - - -	3	24
Red sand- - - - -	4	28

(Continued next page)

Logs of test wells west of the Brazos River in Fort Bend County--Continued

Well 238--Continued

	Thickness (feet)	Depth (feet)
Red clay- - - - -	1½	29½
Sand, caving- - - - -	3	32½
No water sample collected.		

Well 241

25 feet west of highway 36 at Rosenberg city limits, Henry Scott Survey, 3 miles southwest of Richmond.

Black soil- - - - -	4	4
White clay- - - - -	7	11
Brown clay and gravel - - -	2	13
White sandy clay- - - - -	1	14
White sand- - - - -	2	16
Yellow sand - - - - -	1	17
White sand- - - - -	9	26
Red clay- - - - -	6	32
Red sand- - - - -	1	33
Sand- - - - -	1	34

No water sample collected.

Well 248

County road near northwest corner of Shultze 100 acre tract, T. W. Moore Survey, 2 miles southwest of Richmond.

Black surface soil- - - - -	5	5
Red clay- - - - -	3	8
Red sand- - - - -	10	18
White sand- - - - -	12	30
Red clay- - - - -	3	33
Brown sand- - - - -	4	37
Red clay- - - - -		37

No water sample collected.

Well 250

Southside of county road, near Santa Fe R. R., J. W. Moore Survey, 1½ miles southwest of Richmond.

Black soil- - - - -	5	5
Red clay- - - - -	3	8
Red sand- - - - -	8	16
Red clay- - - - -	1	17
Red sand- - - - -	4	21
Red clay- - - - -	11	32
Blue clay - - - - -	15	47
Sand- - - - -	1	48

Struck water at 48 feet.

Water level, 45 feet below top of ground, 12 hours after hole completed.

Water sample collected.

Well 254

Southside of county road, J. T. Edwards Survey, 1 mile southwest of Richmond.

	Thickness (feet)	Depth (feet)
Black surface soil- - - - -	6	6
Red clay- - - - -	6	12
Red sand- - - - -	12	24
Red clay- - - - -	12	36
Gray clay - - - - -	2	38
Red sandy clay- - - - -	2	40
Brown sand- - - - -	5	45
Sand- - - - -	1	46

No water sample collected.

Well 261

Near north corner of C. V. Davidson tract, Jane H. Long Survey, ½ mile south of Richmond.

Depth- - - - -		20
----------------	--	----

Water sample collected.

Well 262

Center of southeast line of C. Y. Davidson tract, Jane H. Long Survey, ¾ mile south of Richmond.

Black soil- - - - -	3	3
Red sandy clay- - - - -	3	6
Brown sand- - - - -	2	8
White sand- - - - -	15	23
Sand- - - - -	1	24

No water sample collected.

Well 263

On east line of Schultze 335 acre tract, and 100 feet northeast of road, Jane H. Long Survey, 1½ mile south of Richmond.

Black surface soil- - - - -	4	4
Blue clay- - - - -	1	5
Red clay- - - - -	5	10
Red sand- - - - -	2	12
White sand- - - - -	9	21
Yellow sand - - - - -	2	23
White sand- - - - -	4	27
Sand- - - - -	1	28

Water level, 28 feet below top of ground, ¼ hour after hole completed.

Water sample collected.

Well 264

Center southwest line of S. J. Winston Estate 1398.9 acre tract, Jane H. Long Survey, 2½ miles southeast of Richmond.

Red loam- - - - -	6	6
Red clay- - - - -	2	8
Red sandy clay- - - - -	7	15
Red clay- - - - -	5	20
Red sand- - - - -	4	24
Red clay- - - - -	5	29
Sand, caving- - - - -		30

No water sample collected.

Logs of test wells west of the Brazos River in Fort Bend County--Continued

Well 255

Southwest line of I. J. Winston Estate 1398.9 acre tract, Jane H. Long Survey, 1,000 feet northwest of south corner, 3 miles southeast of Richmond.

	Thickness (feet)	Depth (feet)
Red soil-	5	5
Red clay-	9	14
Red sand-	2	16
Red clay-	4	20
Red sand-	5	25
Red clay-	5	30
Sand-	1	31

Water level, 21 feet below top of ground, 4 hours after hole completed.

Water sample collected.

Well 267

Side of public road to Booth, Robt. E. Handy Survey, 3 miles southeast of Richmond.

Black surface soil-	3	3
Gray clay-	4	7
Red clay-	3	10
White sand-	14 $\frac{1}{2}$	24 $\frac{1}{2}$
Ball clay-	$\frac{1}{2}$	25
White sand-	1	26

No water sample collected.

Well 268

Side of public road to Booth, Jos. Kuykendall Survey, 3-3/4 miles southeast of Richmond.

Black soil-	4	4
Red clay-	3	7
Red sand-	3	10
Brown sand-	14	24
Sand-	1	25

No water sample collected.

Well 271

Public roadside at south corner of F. G. Have 116.7 acre tract, Robert E. Handy Survey, 4 miles south of Richmond.

Black soil-	4	4
Red clay-	8	12
Brown sand-	11	23
White sand-	8	31

No water sample collected.

Well 272

Public road, near center northeast side of unnamed 179.3 tract, Robt. E. Handy Survey, 3 miles south of Richmond.

Black surface soil-	5	5
Red clay-	8	13
Red sand-	7	20

Well 272--Continued

	Thickness (feet)	Depth (feet)
Red sandy clay-	6	26
Red clay-	4	30
White sand-	4	34
Sand, caving-	1	35

No water sample collected.

Well 273

Near south corner of Ed. Fields 141.2 acre tract, Jane H. Long Survey, 2 $\frac{1}{2}$  miles south of Richmond.

Black soil-	4	4
Gray clay-	2	6
Red clay-	3	9
Brown sand-	7	16
White sand-	1	17
Red sand-	2	19
White sand-	6	25
Sand-	1	26

No water sample collected.

Well 275

Center south line J. T. Dyer 160 acre tract, F. De May Survey, 3 $\frac{1}{2}$  miles south of Richmond.

Black surface soil-	4	4
Red clay-	8	12
Red sand-	10	22
Gray clay-	2	24
Sand-	4	28

Struck water at 20 feet.

Water level, 23 feet below top of ground, 12 hours after hole completed.

Water sample collected.

Well 280

Northeast corner of J.C. Meyer 211 acre tract, G. M. Stone Survey, 5 miles south of Richmond.

Black soil-	4	4
Gray clay-	3	7
Brown clay-	4	11
Red clay-	9	20
Red sandy clay-	3	23
Water-	1	24

Water sample collected.

Well 282

Northeast corner of Mrs. Anna Beyer 100 acre tract, B.B.B. and C. R. R. Co. Survey, 6 miles southwest of Richmond.

Black surface soil-	5	5
Blue clay-	1	6
Light red gravel and clay	2	8
Red clay-	3	11
Brown sand and gravel	1	12
Red sandy clay-	3	15

(Continued next page)

Logs of test wells west of the Brazos River in Fort Bend County--Continued

Well 282--Continued

	Thickness (feet)	Depth (feet)
Red clay- - - - -	5	20
Brown sand- - - - -	7	27
Sand- - - - -	1	28

Water level, 18 feet below top of ground,  
12 hours after hole completed.  
No water sample collected.

Well 284

Center southeast line of W. Krenek 136  
acre tract, S. A. Stone Survey, 5 $\frac{1}{2}$  miles  
southwest of Richmond.

Black soil- - - - -	5	5
Gray clay - - - - -	2	7
Red clay- - - - -	16	23
Sand- - - - -	1	24

Water level, 10 feet below top of ground,  
12 hours after hole completed.  
Water sample collected.

Well 285

Northeast corner of Geo. Fink 80 acre  
tract, S. A. Stone Survey, 4-3/4 miles  
southwest of Richmond.

Sandy soil- - - - -	1	1
White clay- - - - -	4	5
Brown clay- - - - -	2	7
Red sandy clay- - - - -	2	9
Brown sand- - - - -	14	23
Sand- - - - -	1	24

Water sample collected.

Well 286

Northeast corner A. E. Pleak 61 acre  
tract, J. D. Vermillion Survey, 4 $\frac{1}{4}$  miles  
southwest of Richmond.

Depth- - - - -	20
----------------	----

Struck water at 20 feet.  
Water sample collected.

Well 288

Center of east line of D. H. Hillyer  
89.5 acre tract, Henry Scott Survey,  
3-3/4 mile southwest of Richmond.

Black surface soil- - - -	3	3
Blue clay- - - - -	3	6
Red clay- - - - -	5	11
Brown sand- - - - -	5	16
Red clay- - - - -	9	25
Brown sand- - - - -	2	27
Red clay- - - - -	13	40
Blue clay - - - - -	4	44
Sand- - - - -	1	45

Water level, 30 feet below top of  
ground, 12 hours after hole completed.  
Water sample collected.

Well 290

East corner of F. Rosenbaum 154 acre  
tract, section 11 of H. and T. C. R. R.  
Co. Survey, 5 $\frac{1}{2}$  miles southwest of Rich-  
mond.

	Thickness (feet)	Depth (feet)
Black soil- - - - -	5	5
Red clay- - - - -	3	8
Brown sand rock - - - - -	1	9
Red sand- - - - -	1	10
White sand- - - - -	11	21
Fine sand - - - - -	1	22

No water sample collected.

Well 292

$\frac{1}{4}$  mile southwest of north corner on  
northwest line of Jno. Wiezcek 357.5  
acre tract, Jas. Hughes Survey, 5 $\frac{1}{2}$  miles  
southwest of Richmond.

Black soil- - - - -	5	5
Red clay- - - - -	6	11
Red sand- - - - -	11	22

No water sample collected.

Well 304

East corner of W. F. Wehring 73.1 acre  
tract, section 5 of H. & T. C. R. R. Co.  
Survey, 6 $\frac{1}{2}$  miles north of Needville.

Black soil- - - - -	5	5
Brown clay- - - - -	3	8
Red clay- - - - -	4	12
Red sand- - - - -	7	19
Sand- - - - -	1	20

No water sample collected.

Well 306

Center of southwest line of H. Band 527.6  
acres, A. J. James Survey, 6 miles north  
of Needville.

Black soil- - - - -	4	4
Red clay- - - - -	14	18
Red sand- - - - -	2	20

Struck water at 20 feet.  
Water level, 14 feet below top of  
ground, 1 hour after hole completed.  
Water sample collected.

Well 308

Near center of northeast  $\frac{1}{4}$  of Joseph  
Ryba 257.29 acre tract, C. R. Stewart  
Survey, 6 miles north of Richmond.

Black surface soil- - -	4	4
Light red clay- - - - -	1	5
White gravel and clay -	3	8
Red sand- - - - -	5	13
Sand- - - - -	1	14

No water sample collected.



Logs of test wells west of the Brazos River in Fort Bend County--Continued

Well 309

Center of northeast line of S. N. and D. H. Pleak tract, C. B. Stewart Survey, 6 miles northeast of Needville.

	Thickness (feet)	Depth (feet)
Black soil- - - - -	4	4
Red clay- - - - -	6	10
Red sand- - - - -	8	18
Struck water at 18 feet.		
Water level, 17 foot below top of ground, 2 hours after hole completed.		
Water sample collected.		

Well 312

Center west  $\frac{1}{4}$  of L. Barcak 119.25 acre tract, section 94 of H. & T. C. R. R. Co. Survey, 5 miles north of Needville.

Black soil- - - - -	5	5
Gray clay - - - - -	1	6
Red clay- - - - -	22	28
Water level, 18 feet below top of ground, 12 hours after hole completed.		
Water sample collected.		

Well 313

Near center of west line of F. R. Chupik 109.5 acre tract, I. & G. N. R. R. Co. Survey,  $4\frac{1}{2}$  miles north of Needville.

Black surface soil- - - - -	4	4
Blue clay- - - - -	3	7
Red clay- - - - -	17	24
Sand- - - - -	1	25
Water level, 15 feet below top of ground, $\frac{1}{2}$ hour after hole completed.		
No water sample collected.		

Well 314

Center southwest line W. G. Schwartz 148 $\frac{1}{2}$  acre tract, section 68, H. & T. C. R. R. Survey,  $4\frac{1}{2}$  miles northeast of Needville.

Black soil- - - - -	6	6
Red clay- - - - -	4	10
Yellow clay - - - - -	9	19
Red clay- - - - -	4	23
Red sand- - - - -	1	24
No water sample collected.		

Well 315

West corner of D. W. Hand 104 acre tract, Asa Wickson Survey,  $5\frac{1}{2}$  miles northeast of Needville.

Black soil- - - - -	4	4
Brown clay- - - - -	4	8
Red clay- - - - -	12	20

Well 315--Continued

	Thickness (feet)	Depth (feet)
Blue clay- - - - -	7	27
Sand- - - - -	1	28
Struck water at 28 feet.		
Water level, 6 feet below top of ground, 2 hours after hole completed.		
Water sample collected.		

Well 316

Public road near south corner of T. W. Davis 2,028 acre tract, Michael Young Survey, 7 miles northeast of Needville.

Black surface soil- - -	3	3
Gray clay- - - - -	6	9
Red clay- - - - -	6	15
Brown sand- - - - -	3	18
Sand- - - - -	1	19
Struck water at 19 feet.		
Water level, 9 feet below top of ground, 3 hours after hole completed.		
Water sample collected.		

Well 317

Center northwest line of Texas Co. 200 acre tract, Wm. T. Austin Survey,  $7\frac{1}{2}$  miles northeast of Needville.

Black soil- - - - -	6	6
Red clay- - - - -	9	15
Sandy clay- - - - -	4	19
Sand- - - - -	1	20
Struck water at 20 feet.		
Water level, 15 feet below top of ground, 4 hours after hole completed.		
No water sample collected.		

Well 318

East corner of Louise Bleziner 100 acre tract, Barnabas Wickson Survey, 6 miles northeast of Needville.

Black soil- - - - -	6	6
Yellow clay - - - - -	8	14
Blue clay- - - - -	6	20
Red sand- - - - -	2	22
Struck water at 22 feet.		
Water level, 16 feet below top of ground, 3 hours after hole completed.		
Water sample collected.		

Well 325

Near center of northeast  $\frac{1}{2}$  of Frank Sitta 308 acre tract, section 10 of H. & T. C. R. R. Co. Survey,  $3\frac{1}{2}$  miles north of Needville.

Black soil- - - - -	3	3
Gray clay - - - - -	2	5

(Continued next page)

Logs of test wells west of the Brazos River in Fort Bend County--Continued

Well 325--Continued

	Thickness (feet)	Depth (feet)
Brown clay-	3	8
Red clay-	1	9
White clay-	3	12
Red clay-	7	19
Sand and water-	1	20
Struck water at 20 feet.		
Water level, 12 feet below top of ground, 12 hours after hole completed.		
Water sample collected.		

Well 328

Center of northeast  $\frac{1}{2}$  of northwest line of Mrs. C. Bassett 154.16 acre tract, section 71 of H. & T. C. R. R. Co. Survey,  $2\frac{1}{2}$  miles north of Needville.

Black soil-	5	5
Gray clay-	2	7
Brown clay-	1	8
Gray clay-	3	11
Red sand-	2	13
Red clay-	7	20
White clay-	3	23
Red clay-	6	29
Sand-	1	30

Water level, 15 feet below top of ground,  
12 hours after hole completed.  
Water sample collected.

Well 332

Near north corner of H. Banker 166.8 acre tract, section 27 of H. & T. C. R. R. Co. Survey, 1 mile north of Needville.

Black surface soil-	5	5
Red clay and gravel-	5	10
Red clay-	13	23
Blue clay-	5	28
Red clay-	3	31
Lime gravel and blue clay	1	32
Red clay-	11	43
Sand-	1	44

Water level, 24 feet below top of ground,  
24 hours after hole completed.  
Water sample collected.

Well 333

100 feet east of highway 36, section 27 of H. & T. C. R. R. Co. Survey,  $\frac{1}{4}$  mile northeast of Needville.

Black sandy soil-	3	3
Gray clay-	2	5
Red clay-	4	9
Red sand-	3	12
White sand-	8	20
Sand-	1	21

No water sample collected.

Well 336

West corner of A. & M. Bednarech 100.75 acre tract, section 71, H. & T. C. Survey, 2 miles north of Needville.

	Thickness (feet)	Depth (feet)
Black sandy soil-	5	5
White clay-	1	6
Red clay-	7	13
Red sand-	1	14
Red clay-	2	16
Red sand-	1	17
Red clay-	9	26
Red sandy clay-	2	28

No water sample collected.

Well 337

West corner of F. Healy 160 acre tract, section 22 of H. & T. C. R. R. Co. Survey, 2-3/4 miles northwest of Needville.

Black sandy soil-	4	4
Sandy clay and gravel-	2	6
Brown clay-	4	10
Red sand-	6	16
White sand-	4	20
Sand-	2	22

No water sample collected.

Well 339

Near east corner of L. Kramer 77 acre tract, section 19 of H. & T. C. R. R. Co. Survey, 2 miles west of Needville.

Black soil-	6	6
Red clay-	4	10
White sand-	5	15
Red sand-	3	18
White sand-	5	23
Fine sand-	1	24

No water sample collected.

Well 342

West corner B. Ehlert 160 acre tract, section 10 of H. & T. C. R. R. Co. Survey 1 mile southeast of Needville.

Black surface soil-	6	6
Red clay-	2	8
Gray and red clay-	1	9
Brown sand-	3	12
Brown sandy gravel-	2	14
Brown sand-	2	16
Brown sand-	6	22

Water level, 17 feet below top of ground,  
24 hours after hole completed.  
Water sample collected.

Logs of test wells west of the Brazos River in Fort Bend County--Continued

Well 344

Near south corner of R. Rossler 238.3 acre tract, section 40 of H. & T. C. R. R. Co. Survey, 2 miles southeast of Needville.

	Thickness (feet)	Depth (feet)
Black surface soil- - - - -	6	6
Red clay- - - - -	1	7
Gray clay - - - - -	4	11
Red sand- - - - -	3	14
White sand- - - - -	1	15
Brown sand- - - - -	2	17

No water sample collected.

Well 346

Center southwest line of Fritz Hacksted 320 acre tract, section 47 of H. & T. C. R. R. Co. Survey, 2-3/4 miles southeast of Needville.

Black sandy surface soil- - -	3	3
Gray clay- - - - -	2	5
White sandy clay - - - - -	3	8
Yellow sand - - - - -	7	15
Brown sand- - - - -	3	18

No water sample collected.

Well 347

Center southwest line of Fritz Claudt tract, section 59 of H. & T. C. R. R. Co. Survey, 4 1/4 miles southeast of Needville.

Black sandy soil- - - - -	3	3
Red clay- - - - -	3	6
White clay- - - - -	4	10
White sand- - - - -	3	13
Sand- - - - -	4	17

No water sample collected.

Well 350

South corner of J. H. P. Davis 500 acre tract, south corner of Elizabeth Lippincott Survey, 6 1/2 miles east of Needville.

Black soil- - - - -	6	6
Gray clay- - - - -	3	9
Red clay - - - - -	18	27
Red sand - - - - -	2	29

Water level, 17 feet below top of ground, 2 hours after hole completed.  
Water sample collected.

Well 352

East corner of J. H. P. Davis 500 acre tract, Elizabeth Lippincott Survey, 7 1/2 miles east of Needville.

Black sandy soil- - - - -	3	3
Brown sand and gravel - - -	2	5
Red sand- - - - -	1	6
White sand- - - - -	6	12

Struck water at 12 feet.  
Water sample collected.  
Water level, 9 feet below top of ground, 2 hours after hole completed.

Well 354

Center of southeast 1/2 of southwest line of A. T. Horton 240 acre tract, section 64 of H. & T. C. R. R. Co. Survey, 5 1/2 miles southeast of Needville.

	Thickness (feet)	Depth (feet)
Black sandy soil- - - - -	4	4
Brown clay- - - - -	1	8
White sand- - - - -	1	9
Red sand- - - - -	8	17
Sand- - - - -	1	18

Water sample collected.

Well 360

West corner G. W. Armstrong 300 acre tract, Robert Hodges Survey, 4 miles south of Needville.

Black sand- - - - -	7	7
Red clay- - - - -	2	9
Red sand- - - - -	5	14
Sand- - - - -	2	16

No water sample collected.

Well 401

Side of road at Crabb in Joseph Kuykendall Survey, 3 miles west of Booth.

Black surface soil- - - - -	6	6
Gray clay- - - - -	4	10
Red clay- - - - -	12	22
Sand- - - - -	2	24

No water sample collected.

Well 402

Side of public road between Crabb and Smithers Lake, Wiley Martin Survey, 2 1/2 miles west of Booth.

Black soil- - - - -	5	5
Gray clay- - - - -	2	7
Red clay- - - - -	14	21
Red sand - - - - -		22

Water level, 20.2 feet below top of ground, 3 hours after hole completed.  
Water sample not collected.

Well 403

Side of road at Santa Fe R. R. mile post 57, Abner Kuykendall Survey, 1-3/4 miles west of Booth.

Black soil- - - - -	6	6
Gray clay- - - - -	1	7
Yellow clay- - - - -	1	8
Red clay- - - - -	2	10
Blue clay - - - - -	6	16
White sand- - - - -	5	21
Brown sand- - - - -	4	25

(Continued on next page)

Logs of test wells west of the Brazos River in Fort Bend County--Continued

Well 403--Continued

	Thickness (feet)	Depth (feet)
Red sand- - - - -	2	27
Quicksand - - - - -	1	28
Water sample collected.		

Well 404

100 feet north of Santa Fe railroad mile post 56, Abner Kuykendall Survey, 3/4 mile west of Booth.

Black surface soil- - - - -	6	6
Gray clay- - - - -	1	7
Red clay- - - - -	8	15
Red sandy clay- - - - -	5	20
Red clay- - - - -	1	21
Red sand- - - - -	1	22
Yellow sand - - - - -	1	23
Gray clay - - - - -	1	24
Brown sand- - - - -	3	27
Sand- - - - -	1	28

No water sample collected.

Well 408

Near highway on Tom Booth tract, Henry Jones Survey, 1/2 mile east of Booth.

Black soil- - - - -	3	3
Red sand- - - - -	4	7
Red clay- - - - -	1	8
Red sand- - - - -	2	10
Red clay- - - - -	6	16
Water- - - - -	1	17

Water level, 15 feet below top of ground, 12 hours after hole completed.

Water sample collected.

Well 409

County School near R. R. mile post 54 Henry Jones Survey, 1 mile east of Booth.

Black soil- - - - -	3	3
Red clay- - - - -	16	19
Sand- - - - -	1	20

Water level, 12 feet below top of ground, 12 hours after hole completed.

Water sample collected.

Well 410

Center of line of J. W. Slavin 295 acre tract, Henry Jones Survey, 2 miles east of Booth.

Red surface soil- - - - -	5	5
Red clay- - - - -	15	20
Brown sand- - - - -	7	27
Sand- - - - -	1	28

No water sample collected.

Well 411

Southwest corner of J. W. Hampil 48 acre tract, Horatio Chrisman Survey, 3 miles east of Booth.

	Thickness (feet)	Depth (feet)
Black soil- - - - -	4	4
Red clay- - - - -	4	8
Red sandy clay- - - - -	4	12
Red clay- - - - -	8	20
Blue clay - - - - -	1	21
Red clay- - - - -	2	23
Gray clay - - - - -	8	31
Sand- - - - -	1	32

Water level, 18 feet below top of ground, 3 hours after hole completed. Water sample collected.

Well 413

Northwest corner J. M. Byers tract, Horatio Chrisman Survey, 4 miles east of Booth.

Reddish brown clay- - - - -	18	18
Reddish sandy clay- - - - -	2	20
Red sand- - - - -	6	26

Water level, 23 feet below top of ground, 6 hours after hole completed.

Water sample collected.

Well 418

Center west line of J. W. Hampil 125 acre tract, Horatio Chrisman Survey, 5 1/4 miles southeast of Booth.

Red surface soil- - - - -	4	4
Red sandy clay- - - - -	2	6
Red sand- - - - -	9	15
Sand- - - - -	1	16

No water sample collected.

Well 419

Northeast corner of M. W. Shank and J. M. Phillips 100 acre tract, Horatio Chrisman Survey, 5 miles southeast of Booth.

Reddish surface soil- - - - -	6	6
Red clay- - - - -	1	7
Red sandy clay- - - - -	2	9
Brown sand- - - - -	2	11
Red clay- - - - -	5	16
Brown sand- - - - -	4	20
Dark sandy clay - - - - -	2	22
Gray and yellow clay- - - - -	2	24
Sand- - - - -	3	27

No water sample collected.

Logs of test wells west of the Brazos River in Fort Bend County--Continued

Well 421

County road at southeast corner of Jones and Tyler subdivision 1.2 miles southwest of Thompson, Horatio Chrisman Survey, 4 miles southeast of Booth.

	Thickness (feet)	Depth (feet)
Red clay- - - - -	4	4
Red sandy clay- - - - -	9	13
Red sand- - - - -	6	19
Fine sand- - - - -	2	21

Struck water at 21 feet.  
Water level, 18 feet below top of ground, 1 hour after hole completed.  
Water sample collected.

Well 423

County road,  $\frac{1}{4}$  mile south of Smithers Lake and 2-3/4 miles west of Thompson, Edward Jeffrery Survey, 3 $\frac{1}{2}$  miles south of Booth.

Black sandy soil- - - - -	4	4
Red clay- - - - -	3	7
Red sand- - - - -	1	8
Brown sand- - - - -	9	15
White sand- - - - -	6	21
Sand, caving- - - - -	1	22

Water sample collected.

Well 424

Side of road A. P. George 2,433 acre tract, Wiley Martin Survey, 2 $\frac{1}{2}$  miles southwest of Booth.

Black surface soil- - - - -	5	5
Gray clay- - - - -	2	7
Red clay - - - - -	8	15
Red sand- - - - -	2	17
Red clay- - - - -	19	36
Sand- - - - -	1	37

Water level, 19 feet below top of ground, 3 hours after hole completed.  
Water sample collected.

Well 425

Center southwest  $\frac{1}{2}$  of northwest line of A. P. George tract, J. Jones Survey, 2-3/4 miles south of Booth.

Black surface soil- - - - -	6	6
Red clay- - - - -	3	9
Gray clay - - - - -	7	16
Sand- - - - -	2	18

No water sample collected.

Well 426

Northwest corner A. P. George tract, A. D. Kelker Survey, 3-3/4 miles southwest of Booth.

	Thickness (feet)	Depth (feet)
Black soil- - - - -	4	4
Gray clay- - - - -	2	6
Red sandy clay- - - - -	1	7
Red sand - - - - -	1	8
White clay - - - - -	3	11
Red sand- - - - -	7	18

No water sample collected.

Well 427

Center west line of A. P. George tract, H. D. Kelker Survey, 3-3/4 miles southwest of Booth.

Black surface soil* - - - -	5	5
Gray clay- - - - -	3	8
Brown sand - - - - -	9	17
Sand- - - - -	1	18

No water sample collected.

Well 428

South corner of A. P. George 320 acre tract, M. M. Ryon Survey, 5 miles southwest of Booth.

Black sandy surface- - - - -	5	5
Gray clay- - - - -	1	6
Red clay - - - - -	9	15
Red sand- - - - -	5	20
Sand, caving - - - - -	1	21

No water sample collected.

Well 431

North corner Woods 160 acre tract, Chas. D. Sayre Survey, 7 miles south of Booth.

Sandy surface soil- - - - -	6	6
Clay- - - - -	6	12
Sand- - - - -	4	16
Clay- - - - -	2	18
Sand- - - - -	2	20

Struck water at 20 feet.  
Water level, 17 feet below top of ground, 4 hours after hole completed.  
Water sample collected.

Partial analyses of water from wells west of the Brazos River in Fort Bend County, Texas.

(Analyzed at the State University under the direction of Dr. E. P. Schoch, Director of the Bureau of Industrial Chemistry, by J. E. Stullken, C. R. Stewart, D. F. Riddell, and Alfred J. Kelly, Chemists, and J. A. Harmaza, Martin Wieland and Jack Ramsey, Assistant Chemists. Results are in parts per million. Well numbers correspond to numbers in table of well records.)

Well No.	Owner	Depth of well (feet)	Date of collection	Total dissolved solids (calculated)	Calcium (Ca)	Magnesium (Mg)	Sodium and Potassium (Na / K) (calculated)	Bicarbonate (HCO <sub>3</sub> )	Sulphate (SO <sub>4</sub> )	Chloride (Cl)	Total hardness as CaCO <sub>3</sub> (calculated)
5	H.H. Aylor Est.	85	Mar.18,1936	415	77	14	71	397	8	50	249
11	- Zamowitz	139	do.	619	112	21	100	372	17	186	368
13	Joe Hede	76	do.	434	-	-	-	380	8	72	-
15	W.A. Hinsch	375	Mar.19,1936	407	29	18	109	262	8	114	146
25	Leo Turk	92	Apr. 7,1936	411	-	-	-	366	8	64	-
106	C.N. Williamson	95	Apr.21,1936	373	14	14	117	275	21	72	94
110	FarmersGin Company	105	do.	426	84	20	60	439	a/	46	293
111	B.E. Tavner	90	do.	453	-	-	-	451	8	46	-
113	Ed. Behrens	32	May 4, 1936	429	-	-	-	463	6	26	-
114	Willie Sbrush	82	Apr.21,1936	430	73	26	64	456	8	34	291
119	A.E. Quinn	85	do.	591	-	-	-	457	15	102	-
122	Lydia Wenzel	100	Apr. 7, 1936	348	83	9	43	336	8	40	246
124	Willie Mae Wenzel	64	do.	316	58	19	43	344	8	20	222
126	S.P. R.R. Co.	42	do.	1,262	169	91	175	348	86	570	796
127	H.F. Miller	112	do.	361	-	-	-	366	8	32	-
129	Dr. E.R. Knolle	90	do.	480	106	19	61	476	a/	60	342
130	F.J. Mikulancak	110	do.	376	82	19	16	421	a/	52	282
132	Henry Kumaga	70	May 11,1936	517	-	-	-	464	6	82	-
133	F.X. Joerger	90	Apr. 8,1936	479	85	18	81	408	12	82	286
134	W.M. Bolton	110	do.	483	87	27	71	475	a/	64	326
136	F.X. Joerger	96	do.	391	-	-	-	366	a/	58	-
138	Hodde & Glissman	22	do.	494	-	-	-	451	8	72	-
140	Farmers Gin Co.	96	Apr.27,1936	407	31	24	104	427	6	32	175
142	H.A. Krause	50	Apr. 8,1936	463	-	-	-	488	a/	40	-
143	Vencil Bros.	90	do.	409	24	31	100	378	a/	68	189
144	K. Resicke	68	do.	503	-	-	-	512	8	46	-
145	John Holub	86	do.	529	60	22	121	396	25	106	238
147	Dennis Spencer	90	do.	387	53	19	77	342	a/	70	212
149	Fred Gruenwald	100	May 22,1936	425	-	-	-	378	6	68	-
150	Louis Hickman	98	do.	371	-	-	-	354	a/	52	-

a/ Sulphate less than 10 parts per million.

Partial analyses of water from wells west of the Brazos River in Fort Bend County--Continued

Results are in parts per million.

Well No.	Owner	Depth of well (feet)	Date of collection	Total dissolved solids (calculated)	Calcium (Ca)	Magnesium (Mg)	Sodium and Potassium (Na / K) (calculated)	Bicarbonate (HCO <sub>3</sub> )	Sulphate (SO <sub>4</sub> )	Chloride (Cl)	Total hardness as CaCO <sub>3</sub> (calculated)
152	Andrus Estate	90	Apr. 8, 1936	288	-	-	-	305	a/	24	-
154	Joe Bohachek	20	May 4, 1936	624	72	29	138	537	31	90	298
155	Kendleton School	85	do.	494	16	13	170	451	29	44	93
156	Mary Jones	110	do.	475	38	20	126	403	17	74	178
157	Joe Leonard	115	do.	536	-	-	-	537	8	54	-
158	A. Toliver	33	do.	362	-	-	-	378	8	26	-
160	Chas. King Estate	60	May 21, 1936	546	-	-	-	390	42	106	-
161	V.L. King	100	do.	508	50	20	118	275	63	122	207
163	Kate Neal	90	May 22, 1936	716	110	32	124	439	42	192	405
165	H.M. Moore	90	Apr. 8, 1936	1,002	-	-	-	390	135	314	-
166	A.T. Taylor	60	do.	1,071	-	-	-	397	240	260	-
168	R.H. Darst	19	May 22, 1936	479	34	24	126	378	17	92	184
169	Mrs. L.G. Lum	60	do.	543	-	-	-	488	15	78	-
170	W.P.A. test well	17	do.	494	57	25	106	366	10	116	246
171	R.H. Darst	105	Apr. 27, 1936	399	27	17	107	183	8	150	136
172	do.	90	do.	338	-	-	-	342	8	30	-
173	Hy. Fuchs Estate	100	May 4, 1936	460	62	29	86	506	6	28	273
174	Wm. Fuchs Estate	160	do.	532	68	31	103	476	8	88	299
175	K. Guttenberger	100	May 5, 1936	611	-	-	-	494	17	116	-
176	Joseph Teykl	80	May 18, 1936	484	-	-	-	488	a/	54	-
177	C.H. Stegemiller	48	May 5, 1936	732	53	17	224	671	38	70	201
178	Peter Harleca	48	do.	432	52	23	92	421	8	50	224
179	W.P.A. test well	26	May 8, 1936	463	22	23	132	268	a/	154	149
180	do.	24	Apr. 22, 1936	376	42	24	70	183	8	142	205
221	Mary Pleak	85	Apr. 8, 1936	566	-	-	-	463	8	112	-
223	F. Duebbe	40	do.	443	-	-	-	445	a/	50	-
224	Mary Pleak	60	do.	462	-	-	-	476	a/	46	-
225	F.E. Albright	84	do.	384	60	29	55	390	a/	48	268
226	- Chulock	68	do.	443	53	37	72	408	8	72	283
228	Mrs. Ben Meyer	50	do.	399	-	-	-	384	a/	54	-
229	K.I. Dzerzanowski	76	do.	264	33	19	46	256	8	32	162
231	F.M. Stripka	86	do.	385	-	-	-	403	8	28	-
233	W.F. Kelm	82	do.	339	53	19	58	348	a/	38	212
234	Ida S. Schramme	85	do.	429	-	-	-	451	a/	38	-
236	Annie Reve	82	do.	409	85	19	54	433	a/	38	292

a/ Sulphate less than 10 parts per million.

Partial analyses of water from wells west of the Brazos River in Fort Bend County--Continued

Results are in parts per million.

Well No.	Owner	Depth of well (feet)	Date of collection	Total dissolved solids (calculated)	Calcium (Ca)	Magnesium (Mg)	Sodium and Potassium (Na / K) (calculated)	Bicarbonate (HCO <sub>3</sub> )	Sulphate (SO <sub>4</sub> )	Chloride (Cl)	Total hardness as CaCO <sub>3</sub> (calculated)
237	Loney Reve	76	Apr. 5, 1936	431	-	-	-	439	8	38	-
239	T.A. Moore	90	do.	443	74	23	74	451	a/	50	279
240	G.C. Baker	97	do.	412	60	22	77	384	a/	64	238
243	City of Rosenberg well #1	390	May 19, 1936	489	40	13	129	268	17	158	153
245	Adolph Patillo	82	Apr. 27, 1936	417	-	-	-	305	12	96	-
246	H.P. Ross	80	May 28, 1936	548	-	-	-	433	19	106	-
247	County Road	483	Apr. 20, 1936	500	48	33	105	397	25	94	255
249	County Fair Ass'n.	82	May 27, 1936	458	74	19	83	397	15	72	262
250	J.P.A. test well	48	Apr. 12, 1936	815	73	36	205	647	25	158	332
251	S.W. Davis	92	Apr. 13, 1936	510	86	20	90	433	15	86	297
252	- Bruner	50	do.	1,092	61	39	336	976	8	168	314
253	G.A. Reading	80	Apr. 10, 1936	509	-	-	-	317	19	142	-
255	Mrs. Bruner	82	Apr. 23, 1936	439	-	-	-	311	15	104	-
256	Mrs. S.L. Ferris	86	Apr. 11, 1936	273	63	22	13	256	7	42	249
257	Vaclav Pultar	90	May 19, 1936	433	46	19	97	244	27	124	192
258	H.W. Collins	95	do.	327	-	-	-	226	12	80	-
259	J.J. Adams	170	May 29, 1936	342	67	9	53	256	29	58	206
260	City of Richmond	398	Mar. 25, 1936	225	31	9	44	147	17	52	116
261	W.P.A. test well	20	Mar. 10, 1936	296	-	-	-	293	15	22	-
263	do.	28	Mar. 5, 1936	422	-	-	-	415	12	42	-
265	do.	31	May 20, 1936	532	-	-	-	427	38	82	-
266	A. Hagan	100	Mar. 5, 1936	412	25	24	109	342	8	78	160
269	August Meyers	79	Apr. 1, 1936	534	-	-	-	451	12	94	-
270	Fl. Cobb	140	May 7, 1936	545	-	-	-	439	13	106	-
275	W.P.A. test well	28	Apr. 22, 1936	309	-	-	-	330	10	16	-
276	Anton Barcak	82	Apr. 23, 1936	475	84	23	76	451	a/	70	304
277	Aug. Dolezal	106	do.	473	-	-	-	464	6	54	-
278	F.X. Joerger	80	do.	434	-	-	-	439	8	40	-
279	Elo. Ondrej	85	do.	380	54	19	74	384	8	36	212
280	W.P.A. test well	24	do.	1,286	110	36	360	975	12	278	422
281	H.A. Hartlage	80	do.	401	-	-	-	384	8	48	-
283	Max Band	85	Feb. 23, 1936	449	92	20	61	463	6	42	312
284	W.P.A. test well	24	Feb. 24, 1936	431	20	20	129	366	8	74	133

a/ Sulphate less than 10 parts per million.



Partial analyses of water from wells west of the Brazos River in Fort Bend County--Continued

Results are in parts per million.

Well No.	Owner	Depth of well (feet)	Date of collection	Total dissolved solids (calculated)	Calcium (Ca)	Magnesium (Mg)	Sodium and Potassium (Na / K) (calculated)	Bicarbonate (HCO <sub>3</sub> )	Sulphate (SO <sub>4</sub> )	Chloride (Cl)	Total hardness as CaCO <sub>3</sub> (calculated)
285	W.P.A. test well	24	Mar. 29, 1936	589	51	27	155	561	a/	80	236
286	do.	20	May 7, 1936	735	-	-	-	616	10	138	-
287	Emil Frank	132	Apr. 27, 1936	497	98	20	73	463	10	68	327
288	W.P.A. test well	45	Feb. 21, 1936	400	46	13	97	268	a/	112	168
289	Austin Young	92	Apr. 27, 1936	497	75	25	91	463	8	70	290
291	F. Rosenbaum	90	May 11, 1936	491	-	-	-	463	12	60	-
293	H.A. Meyer	70	Apr. 27, 1936	471	58	28	95	451	8	60	257
294	K. Hillyer	82	do.	505	-	-	-	439	10	84	-
295	Albert Cominsky	-	May 21, 1936	497	-	-	-	488	a/	62	-
301	W.M. Lampe	80	do.	327	33	17	73	170	a/	120	150
302	A. Reehs	108	Apr. 27, 1936	542	60	28	120	451	10	102	262
303	Frank Broecke	84	May 21, 1936	543	-	-	-	488	8	84	-
305	A.W. Steglich	125	Apr. 27, 1936	483	75	24	86	415	6	88	285
306	W.P.A. test well	20	do.	500	-	-	-	439	15	76	-
307	Joe Sitta	50	Apr. 23, 1936	397	-	-	-	403	8	36	-
309	W.P.A. test well	18	Apr. 24, 1936	628	32	23	195	549	8	100	174
310	Joe Poncik	110	do.	510	93	23	80	476	8	72	325
311	R.J. Foss	192	do.	563	78	23	113	427	29	110	289
312	W.P.A. test well	28	Feb. 26, 1936	1,252	111	66	262	287	176	496	545
315	do.	28	Apr. 24, 1936	666	76	31	141	463	58	132	319
316	do.	19	Mar. 20, 1936	803	-	-	-	323	79	272	-
318	do.	22	May 7, 1936	565	-	-	-	360	34	142	-
320	Francis Psencik	27	do.	263	32	12	55	159	12	74	127
321	do.	30	do.	894	-	-	-	439	52	294	-
322	Farmers Gin Co.	100	do.	524	78	21	103	427	6	106	283
323	do.	67	do.	452	47	26	99	378	6	88	226
324	John Dudek	26	do.	603	-	-	-	427	13	150	-
325	W.P.A. test well	20	Feb. 25, 1936	1,212	-	-	-	110	693	90	-
326	Rudolph Sitta	90	Apr. 24, 1936	358	-	-	-	354	6	38	-
327	John Kubena	52	May 6, 1936	501	75	17	105	451	6	76	255
328	W.P.A. test well	30	Feb. 27, 1936	531	27	19	164	463	19	74	147
330	M. Schroder	116	Apr. 24, 1936	416	51	26	80	384	10	60	236
331	Chas. Staffin	38	Apr. 22, 1936	995	-	-	-	549	12	338	-
332	W.P.A. test well	44	Feb. 28, 1936	531	-	-	-	537	a/	58	-

a/ Sulphate less than 10 parts per million.

Partial analyses of water from wells west of the Brazos River in Fort Bend County--Continued

Results are in parts per million.

Well No.	Owner	Depth of well (feet)	Date of collection	Total dissolved solids (calculated)	Calcium (Ca)	Magnesium (Mg)	Sodium and Potassium (Na / K) (calculated)	Bicarbonate (HCO <sub>3</sub> )	Sulphate (SO <sub>4</sub> )	Chloride (Cl)	Total hardness as CaCO <sub>3</sub> (calculated)
334	G. M. Goldsmith	103	Apr. 22, 1936	412	57	17	85	336	8	80	210
335	H.A. Leisner	110	May 5, 1936	471	-	-	-	403	13	78	-
338	W.C. Otto	108	do.	479	75	17	95	415	8	80	255
340	H.A. Bushnell	90	May 30, 1936	465	80	15	88	476	8	40	264
342	W.P.A. test well	22	Feb. 25, 1936	281	75	18	12	317	a/	20	261
345	August Leus	24	Apr. 22, 1936	441	-	-	-	396	a/	74	-
348	L.F. Goth	28	May 6, 1936	422	-	-	-	427	a/	46	-
349	F. Dedek	40	May 7, 1936	903	-	-	-	439	242	128	-
350	W.P.A. test well	29	May 1, 1936	472	-	-	-	470	17	40	-
351	Texas Gulf Sulphur Company	556	May 6, 1936	422	52	20	87	317	25	82	212
352	W.P.A. test well	12	May 1, 1936	2,321	230	131	452	134	128	1,314	1,111
353	Aug. Bosak	110	May 5, 1936	666	44	23	197	580	19	98	204
354	W.P.A. test well	18	Mar. 4, 1936	1,251	-	-	-	384	87	520	-
355	Barbara Koler	95	May 5, 1936	586	-	-	-	439	12	134	-
356	John Strecik	100	Apr. 22, 1936	368	74	15	53	366	a/	46	249
358	J.R. Farmer	23	May 18, 1936	457	-	-	-	451	6	50	-
359	John Petrusek	58	May 5, 1936	637	-	-	-	427	15	170	-
361	Wm. C. Banker	108	May 18, 1936	706	118	31	115	439	12	214	424
405	Booth Estate	421	-	315	64	16	37	262	17	52	225
406	T.R. Booth	179	Apr. 2, 1936	289	49	18	41	268	15	34	196
407	Booth Estate	300	Mar. 10, 1936	311	41	10	70	287	17	32	146
408	W.P.A. test well	17	Mar. 9, 1936	316	54	67	-	171	73	38	411
409	do.	20	do.	1,236	-	-	-	355	456	192	-
411	do.	32	Mar. 10, 1936	3,091	248	169	508	397	1,863	108	1,314
413	do.	26	do.	2,551	-	-	-	294	1,521	100	-
414	County School	420	May 28, 1936	290	47	10	57	293	a/	32	161
416	- Scott	90	Mar. 10, 1936	470	69	36	69	463	8	60	322
417	J.W. Hampil	60	do.	672	-	-	-	665	37	48	-
420	Rudolph Gubbels	185	May 12, 1936	297	50	12	55	305	a/	30	172
421	W.P.A. test well	21	do.	1,028	32	59	288	764	196	80	316
422	Y.U. Jones Estate	209	Apr. 4, 1936	283	56	12	41	275	13	26	187
423	W.P.A. test well	22	May 11, 1936	441	-	-	-	378	4	80	-
424	do.	37	Mar. 12, 1936	2,610	202	120	548	366	840	720	999

a/ Sulphate less than 10 parts per million.

Partial analyses of water from wells west of the Brazos River in Fort Bend County--Continued

Results are in parts per million.

Well No.	Owner	Depth of well (feet)	Date of collection	Total dissolved solids (calculated)	Calcium (Ca)	Magnesium (Mg)	Sodium and Potassium (Na / K) (calculated)	Bicarbonate (HCO <sub>3</sub> )	Sulphate (SO <sub>4</sub> )	Chloride (Cl)	Total hardness as CaCO <sub>3</sub> (calculated)
429	Percy Gonyo	85	May 1, 1936	541	-	-	-	329	8	166	-
430	Slavik Estate	85	do.	426	82	13	68	329	17	84	258
431	W.P.A. test well	20	May 13, 1936	798	-	-	-	171	34	390	-
432	H. O. & R. Co.	590	May 12, 1936	293	39	10	67	287	a/	36	141
433	Ralph Rawlings	105	May 6, 1936	416	-	-	-	348	15	70	-
434	T.A. Brown	130	do.	611	107	24	100	403	12	170	365
435	J. H. P. Davis	80	do.	336	51	17	62	317	a/	50	195
436	J.M. Mitchen	86	May 13, 1936	362	-	-	-	348	8	42	-

a/ Sulphate less than 10 parts per million.

INDEX MAP OF FORT BEND COUNTY, WEST OF BRAZOS RIVER,  
SHOWING LOCATION OF PLATES 1, 2, 3, 4, AND 5.

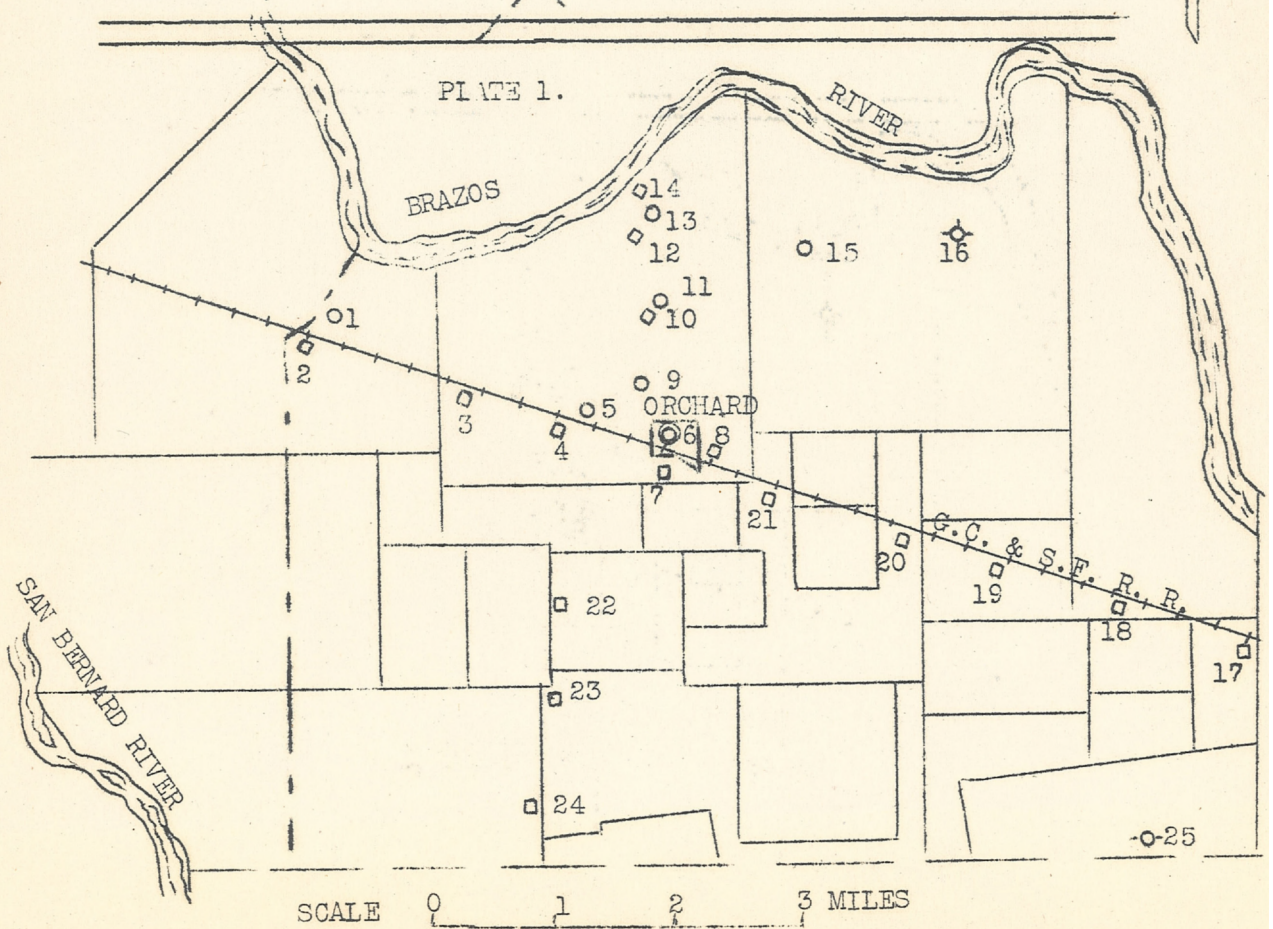
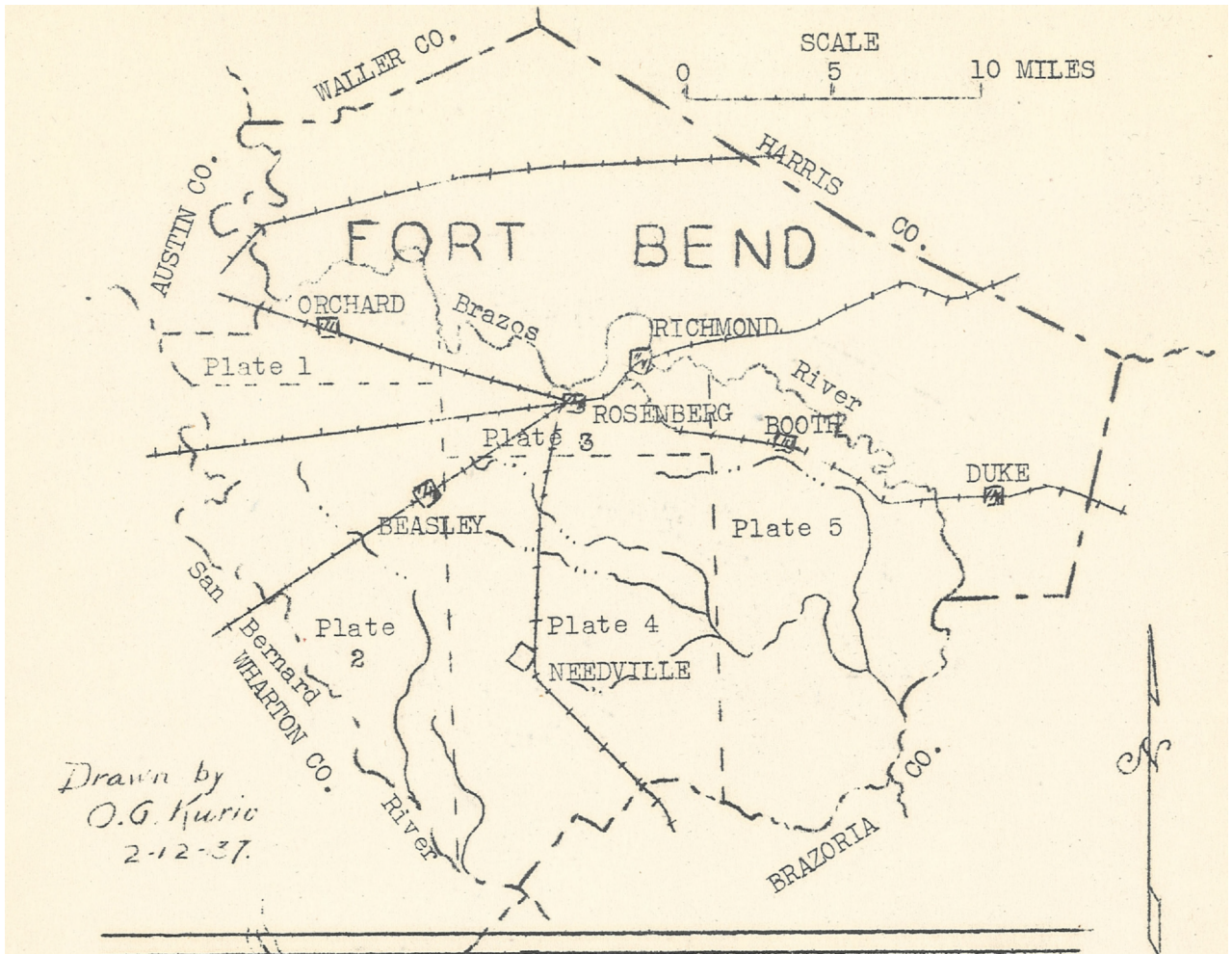

NOTE; SEE PLATE 3 FOR EXPLANATION OF SYMBOLS.



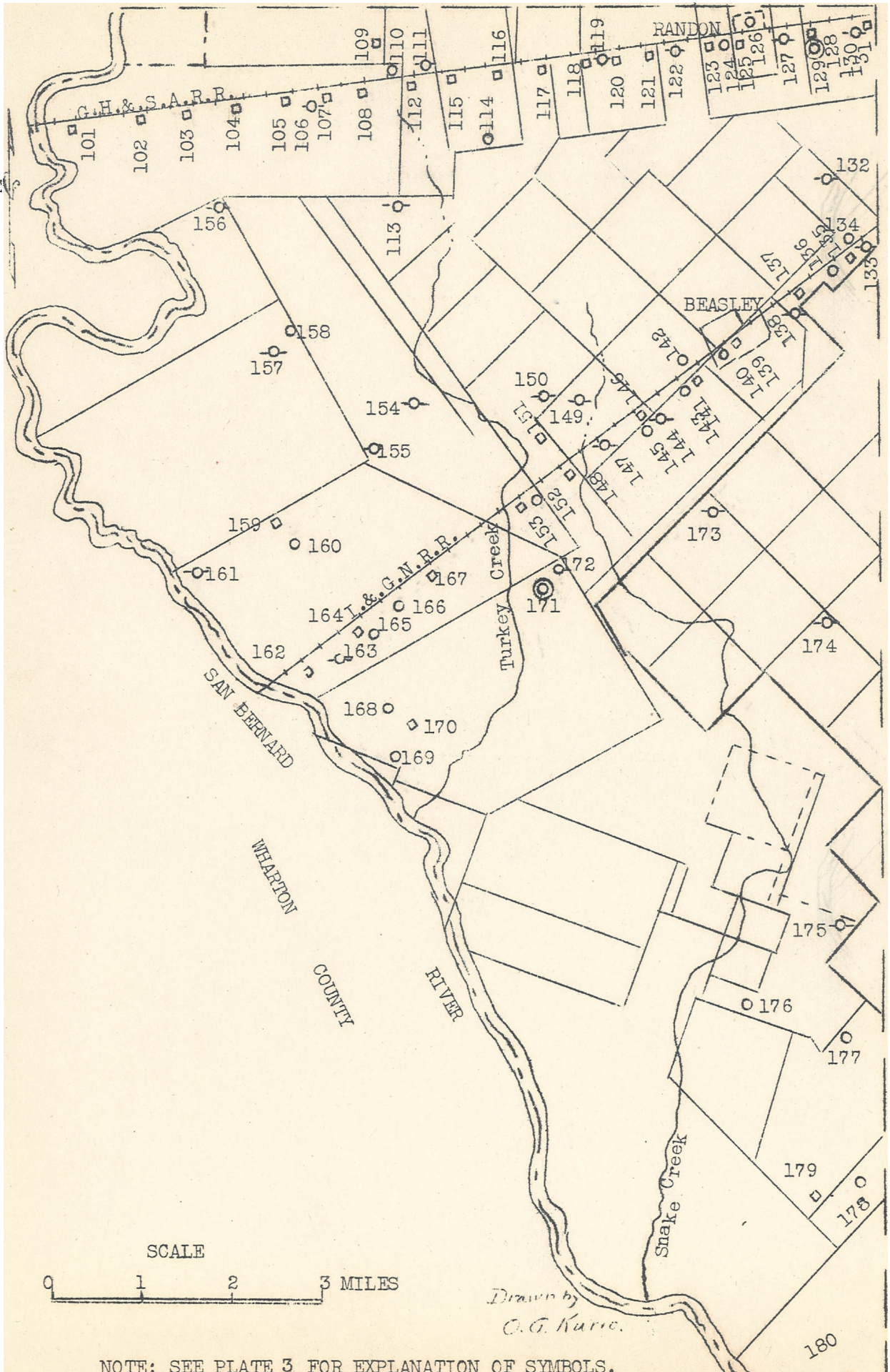

NOTE: SEE PLATE 3 FOR EXPLANATION OF SYMBOLS.



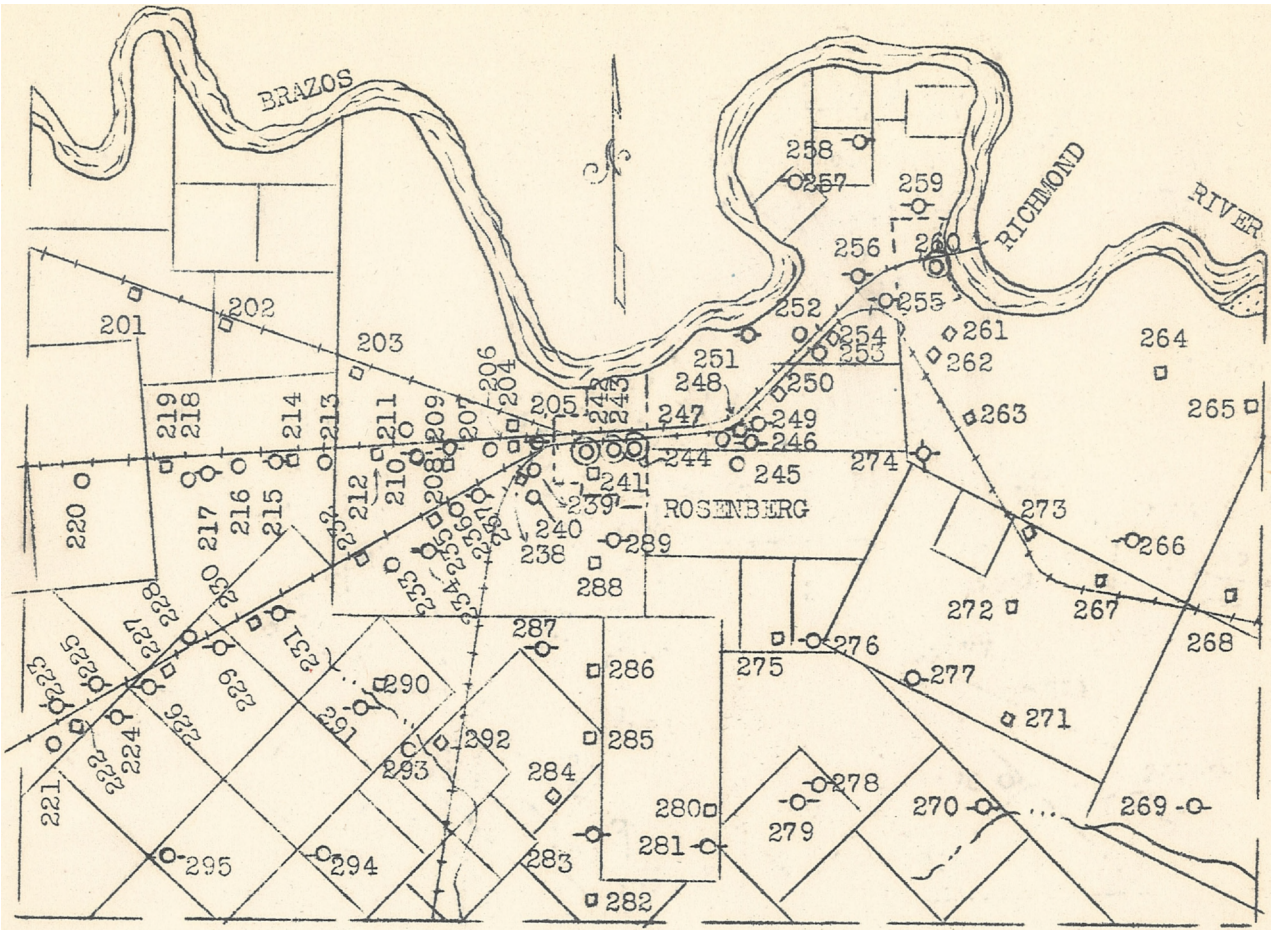

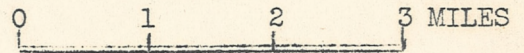

SCALE



EXPLANATION OF SYMBOLS USED ON PLATES 1 TO 5 INCLUSIVE.

- Well with hand pump or bucket.
- Well with windmill or small power pump.
- ⊙ Well with pumping plant--5 horsepower or larger.
- ⊕ Well drilled to test for oil or gas.
- ◊ Unused well.
- ◻ Test well drilled by W.P.A. labor.

 Railroad.

 Creek.

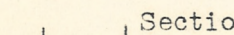
 Section or survey lines.

Drawn by  
C.G. Kurio.  
2-12-37.



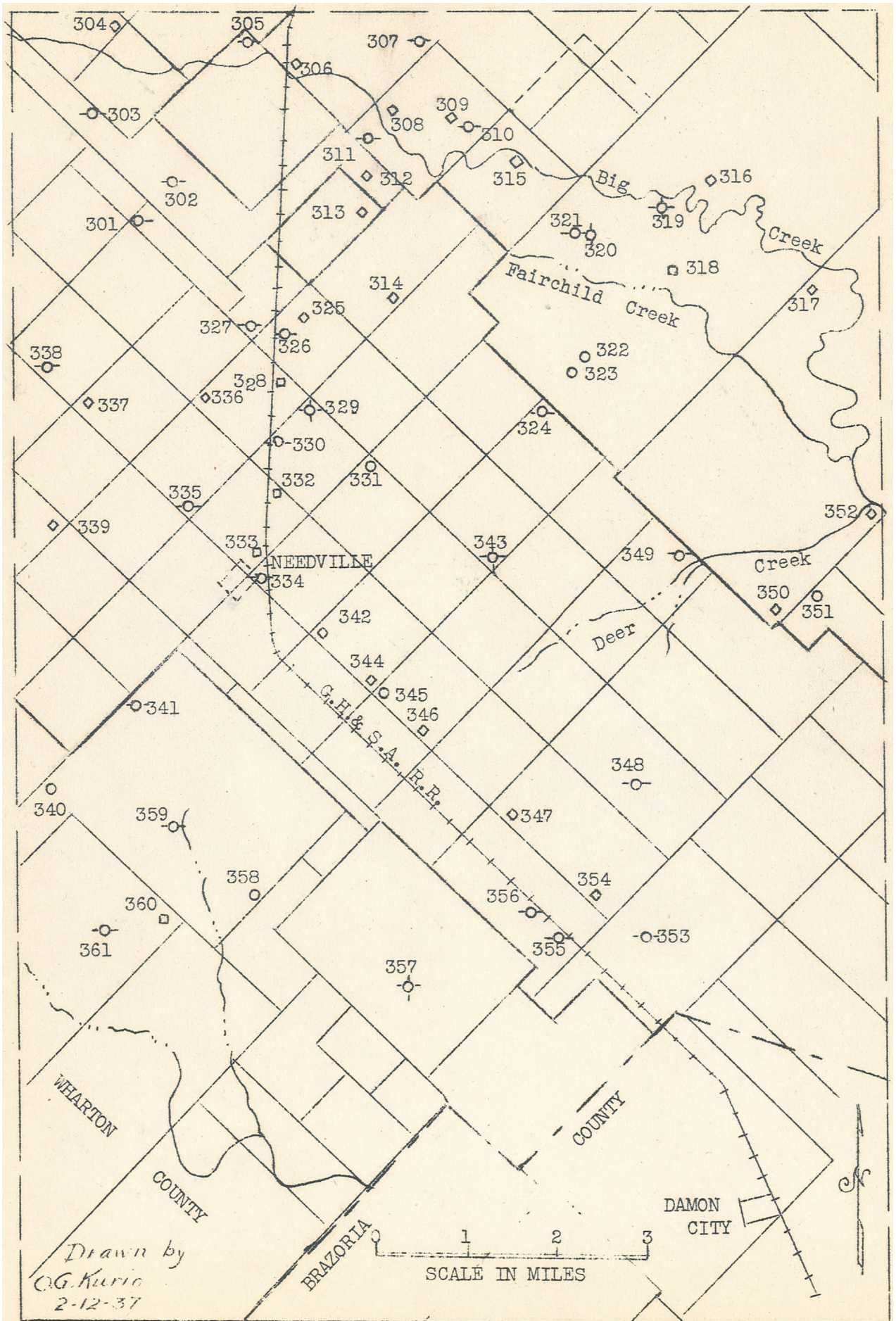

NOTE: SEE PLATE 3 FOR EXPLANATION OF SYMBOLS.



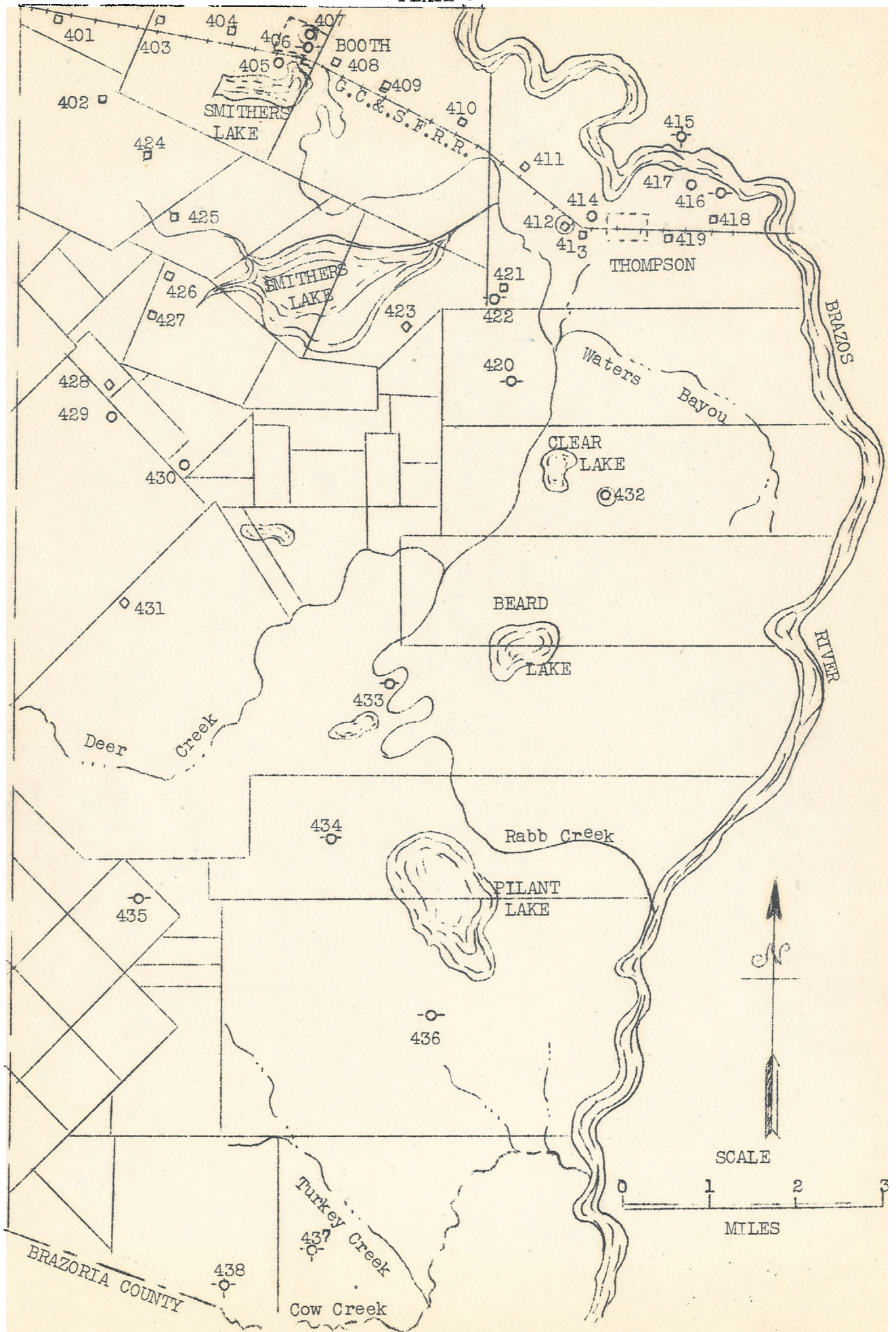

NOTE: SEE PLATE 3 FOR EXPLANATION OF SYMBOLS